



PAVEMENT MAINTENANCE PRODUCTS AND ACCESSORIES CATALOG

EQUIPMENT

- SEALCOATING EQUIPMENT
- PORTABLE SPRAY UNITS
- CRACKSEAL MELTERS
- SMALL MASTIC MELTERS
- DUAL DIAPHRAGM PUMPS
- PARTS & ACCESSORIES

ASPHALT COATINGS



CRACK SEALING



LINE STRIPING



RECREATIONAL SURFACING



PAVEMENT REPAIR



APPLICATION TOOLS



WWW.MAINTINC.COM • 800-892-6701

MAINTENANCE INC.

Our Products, Our People, Our Place

The Smart Choice Since 1938

www.maintinc.com



ABLE
INDUSTRIES



SEALER ADDITIVES

Fast Sealing Additive	1
Fass-Dri	1
FSA AE	2
Target Plus	2

ASPHALT COATINGS

Fass Dri Resurfacer	3
Backer Rod	3
J-16 Sealer.	4

CRACK SEALING

Lastek 400 Direct Fire	5
Macseal BDM	6
Pure Ashpalt.	6
Laskek 33	7
Lastek HyFlex	7
Crack Rite	8
Quik-Joint	8
MA10 Melter/App.	9
10-30-55 Gallon Melters	9
Pour Pots	9
MA10 Melter/App. Parts	10
RY2x2-IR	11
Elite Melter Applicator	11-12
V Squeegees	13
Asphalt Scrapers	13
Crack Filling Squeegees	13
Crack Hoe	13

FSA[®] FAST SEALING ADDITIVE

- Stops tracking • Improves sand dispersion
- Use with all sealers • Dries Fast



The original fast sealing additive from Maintenance, Inc. Improves gas & oil resistance, stops tracking, and dries fast while enhancing the flexibility of the sealer film. FSA improves sand dispersion while reducing curing time by 50% or more. **Use With: Asphalt Emulsion Sealers, or Blends.**

Suggested Formula Range:

PAVEMENT SEALER — 100 Gals. WATER — 10 to 35 Gals. PAVEMENT SEALER — 100 Gals.
FSA ADDITIVE — 2 to 5 Gals. SAND — 300 to 500 Lbs. FSA ADDITIVE — 7 to 10 Gals.

Cold Weather Formula Range

PAVEMENT SEALER — 100 Gals. WATER — 10 to 30 Gals.
SAND — 300 to 500 Lbs.

PART NO.	DESCRIPTION	SHIPPING WT.	CONTRACTOR PRICE
3FSA5	5 Gal. Pail	48 lbs.	\$75.95/pail
3FSA55	55 Gal. Fiber Drum	525 lbs.	795.00/dr.

FASS-DRI[™] PAVEMENT SEALER ADDITIVE

FASS-DRI Pavement Sealer Additive is the result of an exciting break-through in additive chemistry. It enables you to **open parking lots to traffic in as little as 30 minutes**. Jobs can be completed faster – lots can be striped quicker for reduced down times.

Packaging: In convenient **easy-to-handle 2-gallon pails**, or conventional 5-gallon pails.

Suggested Formula Range: Add 2 gallons of Fass-Dri PSA to 100-150 gallons of concentrated sealer. Add water and sand per manufacturer’s recommendation.

PART NO.	DESCRIPTION	SHIPPING WT.	CONTRACTOR PRICE
3FDPSA2	2 Gal. Pail (48 per skid)	28 lbs.	\$51.95/ea.
3FDPSA5	5 Gal. Pail (36 per skid)	70 lbs.	130.00/ea.

Suggested Formula Range:

PAVEMENT SEALER — 100 Gals. WATER — 10 to 35 Gals.
FASS DRI PSA — 2 to 5 Gals. SAND — 300 to 500 Lbs.

- The latest advancement in fast dry technology for the fastest drying times.
- Fortified with SSA (Sand Suspension Additive) for Dual Action performance... fast cure and sand suspension.
- The blackest color – The toughest film.
- Ideal for asphalt emulsion or blended sealers.



Suggested Night Time Range:

PAVEMENT SEALER — 100 Gals. WATER — 10 to 30 Gals.
FASS DRI PSA — 7 to 10 Gals. SAND — 300 to 500 Lbs.



Superior sand suspension for uniform applications, **added resistance to gasoline, fuels, and oils, rubberizes sealer for increased scuff resistance and reduced power steering marks,** and **speeds up drying time of the sealer.**

Suggested Formula Range: Add 2 to 4 gallons of TARGEL PLUS to 100 gallons of concentrated pavement sealer. Add water and sand per manufacturers recommendations. (NOTE: Always dilute TARGEL PLUS 1:1 with water prior to addition to mix.)

- Meets FAA Specs for pavement sealer additives.
- Fortified with fast drying additive.

Multi-Dimensional additive that greatly enhances the overall performance of coal tar emulsions, asphalt emulsions, or blended pavement sealer products. Does thicken asphalt based and blended sealers.

PART NO.	DESCRIPTION	SHIPPING WT.	CONTRACTOR PRICE
3TGP5	5 Gal. Pail	48 lbs.	\$130.00/pail



ASPHALT COATINGS

FASS-DRI™

ASPHALT RESURFACER

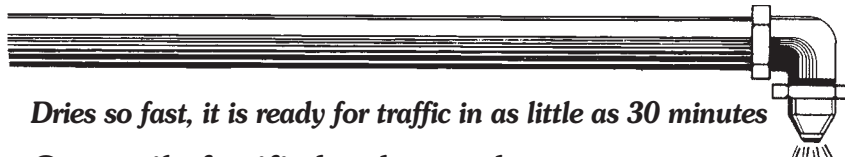

- Dries so fast, it is ready for traffic in as little as 30 minutes
- Geotextile fortified to be tough
- Long lasting protection
- Slip resistant
- No tracking

Sprayable*
Can be applied with
conventional sealer
spray equipment



Application: FASS-DRI Asphalt Resurfacer is available in a ready-to-use, pre-mixed form or as a two component system. The two component system consists of a liquid that requires the addition of a precise proportion of special silica sand. The liquid can be purchased with or without this sand.

***Spray Applications:** For best performance, hose length should not exceed 100 ft. (from pump to spray wand), and use an 80/50 ceramic spray tip.

Coverage: 80-100 sq. ft. per gallon per coat (2 coats recommended).

FASS-DRI Resurfacer is used on many major motor racing tracks nationwide.



Asphalt resurfacing without 12 to 24 hours of downtime means minimal loss of business to your customer and lets you, the contractor, turn nuisance work into quick, highly profitable jobs. This non-tracking, rich slate black finish offers long lasting protection from temperature change, stress, abrasion and chemicals. FASS-DRI is reinforced with geotextile fibers for increased flexibility and tensile strength. Resurface existing asphalt pavement with the only asphalt coating that is classified by Underwriters Laboratories for slip resistance. FASS-DRI is the preferred product for service stations, fast food restaurants, convenience stores, banks, hospitals, golf courses, motor sports tracks, airport taxiways, etc.

PART NO.	DESCRIPTION	SHIPPING WT.	CONTRACTOR PRICE
3FD5	Ready to Use 5 Gal. Pail	65 lbs.	\$35.00
3FDAE5	Ready to Use 5 Gal. Pail	65 lbs.	35.00

BACKER ROD

JOINT SEALANT BEDDING & BACKUP MATERIAL

- Unique filler/bed for deep cracks or joints
- Compatible with hot or cold applied sealant
- Stops waste of costly sealant material

A unique, round, continuous-length, compressible foam material that helps ensure proper performance of the sealing system. It has an open cell structure that allows air flow to speed sealant drying and curing from both the top and bottom. Being hydrophobic, it will not wick water. BACKER ROD can be used with hot or cold applied sealant material.

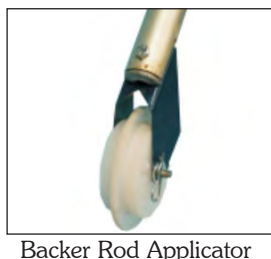
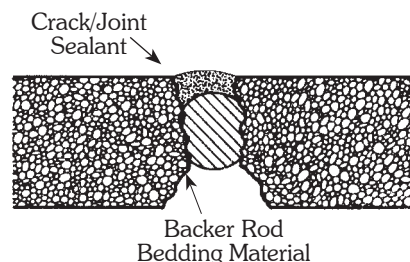

Application: Recommended size per crack/joint width:

BACKER ROD Diameter	3/8"	5/8"	7/8"	1-1/8"	1-1/2"	2"
Crack/Joint Width	1/4"	1/2"	3/4"	1"	1-1/4"	1-1/2"

PART NO.	DESCRIPTION	SHIPPING WT.	CONTRACTOR PRICE
Packaged in continuous length bales wrapped in preshrunk transparent poly bags Binder-twine coiled to easily dispense from the center.			
8BR-37S	3/8" Dia. x 200' Bag	1 lb.	\$39.00/ea.
8BR-37L	3/8" Dia. x 3600' Bag	30 lbs.	465.00/ea.
8BR-62S	5/8" Dia. x 100' Bag	1 lb.	17.00/ea.
8BR-62L	5/8" Dia. x 2000' Bag	20 lbs.	260.00/ea.
8BR-87S	7/8" Dia. x 100' Bag	2 lbs.	28.00/ea.
8BR-87L	7/8" Dia. x 1050' Bag	15 lbs.	235.00/ea.
8BR-112S	1-1/8" Dia. x 75' Bag	2 lbs.	30.00/ea.
8BR-112L	1-1/8" Dia. x 600' Bag	14 lbs.	200.00/ea.
8BR-150S	1-1/2" Dia. x 40' Bag	2 lbs.	38.00/ea.
8BR-150L	1-1/2" Dia. x 350' Bag	18 lbs.	220.00/ea.
8BR-200S	2" Dia. x 25' Bag	3 lbs.	44.00/ea.
8BR-200L	2" Dia. x 200' Bag	20 lbs.	230.00/ea.
8BRAT	Applicator	4 lbs.	58.00/ea.

Certificate of Authenticity



MAINTENANCE, INC.

This is to certify that **Advanced Formula J-16[®] Authorized Applicator** was applied on

Name of Job

Authorized Applicator

Completion Date

**Become an Authorized J-16 Applicator. Call Today and find out more!
800-892-6701**



Advanced Formula J-16[®] Driveway Sealer

READY-TO-USE

- **A ready-to-use version of the original contractor grade Advanced Formula J-16[®] Pavement Sealer**
- **The best choice to protect and beautify your asphalt parking lots and driveways**

Also available in Asphalt based J-16 AE RTU

Application: Use hand squeegees or brush applicators. Brush applicators are best on extremely smooth or rough open-textured surfaces. A previously unsealed driveway or one in marginal condition may require 2 coats of J-16 DRIVEWAY SEALER.

J-16 DRIVEWAY SEALER is available in two (2) grades — Plain (no sand) and Sand-Filled. Use Sand-Filled on the first coat over new asphalt, on moderate to heavy traffic areas for extra wear or on areas where extra traction and slip resistance are needed.

Beware of inexpensive, watered-down, discount store sealers. The best looking, longest lasting off-street asphalt pavements are protected with ADVANCED FORMULA J-16 DRIVEWAY SEALER. Unlike most sealers, it keeps natural elements, de-icing salts and automobile deposits from penetrating asphalt. Gas and oil can't eat it away. The sun can't dry it out. Winter moisture can't seep in, freeze and rip it apart. And summer rain can't erode the foundation. ADVANCED FORMULA J-16 DRIVEWAY SEALER extends pavement service life and makes pavements easier to clean. This unique, premium quality formulation lets you do it yourself with no costly mixing equipment. Easy-to-follow application directions are printed on every container.

Coverage: Quantities required will vary with porosity and texture of pavement surface, but general ranges are as follows:

PART NO.	DESCRIPTION	SHIPPING WT.	CONTRACTOR PRICE
3J16RTU	Plain Grade (No Sand) 5 Gal. Plastic Pail	55 lbs.	\$31.00
3J16AERTU	Plain Grade (No Sand) 5 Gal. Plastic Pail	55 lbs.	31.00
730	Sand	50 lbs.	8.80



SEALER GRADE	GALLONS NEEDED
1st COAT J-16 Plain	.10-.12 gal. per sq. yd.
2nd COAT J-16 Plain	.08-.12 gal. per sq. yd.
1st COAT J-16	.10-.15 gal. per sq. yd.
2nd COAT J-16 Plain	.08-.10 gal. per sq. yd.

LASTEK® 400 DIRECT FIRE

CONTRACTOR GRADE

HOT APPLIED JOINT AND CRACKFILLER

2-25# BLOCKS PER CTN



PART NO.	DESCRIPTION	SHIPPING WT.	CONTRACTOR PRICE
3L400DF	50 lb. Cartons	50 lbs.	.80¢/lb.

Lastek 400 DF (Direct Fire) is a single component joint and crack sealant specifically designed for use with a Direct Fired, single walled Melter. Lastek 400 DF is manufactured using select engineered asphalt cements, polymers, select oil resins and UV inhibitors. Lastek 400 DF will not flow from the joint or be picked up by vehicle tires, foot traffic, skateboards or roller blade wheels in high surface temperatures.

Lastek 400 DF was designed for the routine maintenance of asphalt concrete pavements or Portland Cement Concrete on driveways, parking lots, bicycle paths and walkways.

Melting Equipment: Lastek 400 DF was designed to be melted in a direct fire Melter equipped with either a hand operated or mechanically operated agitator or in a Oil Jacketed Melter with an agitator. The kettle should have a thermometer for the melting vat.

Coverage: Lastek 400 DF weighs approximately 9.5lbs./gal (1.14 kg/L). A joint ½" x ½" (12.7mm x 12.7mm) required approximately 12 lbs. Per 100 lineal feet or 17.7 kgs per 100 lineal meters.

Packaging: 2x25 lb. (1-1.33kg) polybags in a high-strength corrugated cardboard container.

Application Temperatures: Recommended pouring temperature 365°F.

PURE ASPHALT MASTIC

IRONS FOR
MASTIC
APPLICATION



EQUIPMENT
FOR MASTIC
APPLICATION

PART NO.	DESCRIPTION	SHIPPING WT.	CONTRACTOR PRICE
MT40	40 lb. Box	40 lbs.	.71¢/lb

MACSEAL BDM

HOT APPLIED JOINT AND CRACK SEALER FOR USE IN OIL JACKET MELTER 2-25LB. BLOCKS PER CONTAINER

MACSEAL BDM CRACK SEALANT is recommended for the large scale sealing of joints and random cracks in in portland cement concrete and asphalt pavements. It will provide good protection against repeated freeze thaw cycles.

MACSEAL BDM CRACK SEALANT is a premium quality, high performance hot applied, single component joint and crack sealant.

MACSEAL BDM CRACK SEALANT offers advanced low temperature bonding properties, prolonged resistance to degradation from weather and a positive seal during the expansion and contraction of the joint or crack. It remains ductile and highly resilient at low and high service temperatures.

PART NO.	DESCRIPTION	SHIPPING WT.	CONTRACTOR PRICE
3MSBDM	50 lb. Cartons	50 lbs.	.80¢/lb.

TEST	TYPICAL DATA	SPEC RANGE	
		Min	Max
Flash Point (COC), °C	275
Cone Penetration, 25°, dmm	52	30	35
Flow, 60°C, mm	0	...	3
Softening Point R&B, °C	91	88	93
Ductility, 25°C, cm	35	30	...
Resilience, 25°C, %	68	40	...

PURE ASPHALT



PART NO.	DESCRIPTION	SHIPPING WT.	CONTRACTOR PRICE
DF30	30 lb. Box	30 lbs.	.85¢/lb
DF50	50 lb. Box	50 lbs.	\$42.50/box
PL30	30 lb. Box	30 lbs.	.80¢/lb
PL50	50 lb. Box	50 lbs.	\$24.00/box

CRACK SEALING



LASTEK® 33

RUBBERIZED LIQUID CRACK SEALER

- Elastic, ready-to-use sealer - just pour it in
- Dries fast
- Provides years of protection

LASTEK 33 is a one (1) component, pourable, high performance, black, rubberized asphalt emulsion-based crack sealer. It is ideal for filling cracks up to 1/2" wide in any asphalt or concrete surface.

PART NO.	DESCRIPTION	SHIPPING WT.	CONTRACTOR PRICE
3L335	5 Gal. Plastic Pail	48 lbs.	\$56.00/pail
3L331	1 Gal. Plastic Jug	10 lbs.	16.25/jug



FOR CRACKS UP TO 1/2" WIDE

Coverage: 1 gallon fills 200-225 linear feet of 1/4"x 1/4" cracks.

Application: Clean dust, dirt, or loose material from the cracks. Fill with LASTEK 33. Squeegee off any excess flush with the surface. Cracks over 1/2" deep should first be partially filled with sand or backer rod Broadcast dry sand over freshly sealed cracks. Caution: Do not apply below 50°F. Do not use when rain is imminent. Do not use in cracks over 1/2" wide. (For cracks over 1/2" wide, use LASTEK CP-3405 CRACK SEALANT - SEE BELOW.)

LASTEK® HYFLEX

Our new Lastek HyFlex is a fast setting, ready to use , high performance cold pourable crack sealer. Ideal for use on all asphalt or concrete surfaces.

- Fast setting, Self leveling
- Ready to use, Easy pour jug
- For use on cracks up to 1/2" wide

Application: Mix Lastek HyFlex until a smooth consistency is achieved. Pour Lastek HyFlex into cracks to surface level, squeegee off any excess material. Lastek HyFlex is a cold applied elastomeric liquid crack sealant.

Coverage: Typical coverage is 200-225 linear feet per gallon, 1/4"x 1/4" x 1/4" crack

PART NO.	DESCRIPTION	SHIPPING WT.	CONTRACTOR PRICE
3LHFLEX5	5 Gal. Pail	50 lbs.	\$56.00/pail
3LHFLEX1	1 Gal. Jug	10 lbs.	16.25/jug



READY-TO-USE

FAST DRYING

CRACK SEALANT

HyFlex is available in 1 gallon, 5 gallon, and 55-gallon containers.



HyFlex Coverage Rate:

One gallon of HyFlex will seal approximately 75 linear feet of 1/2" wide x 1/2" deep cracks. Ultimately, coverage is dependant upon depth and width of cracks.



CRACK•RITE™ CRACK•STIX

**DIRECT HEAT RUBBERIZED
CRACK & JOINT SEALANT
FOR ASPHALT OR CONCRETE**

- No melters or pour pots needed
- Easy-to-use, professional results
- No tracking
- Traffic ready in 20 minutes

Uncoil, cut to length, pack and heat with propane torch and your crack repairs are complete.

PART NO.	DESCRIPTION	SHIPPING WT.	CONTRACTOR PRICE
8CS125	1/2" x 125' Pail Black	10 lbs.	\$60.00/ea
8CS125G	1/2" x 125' Pail Gray	10 lbs.	65.00/ea
8CSTORCH	Bernz-O-Matic Torch	5 lbs.	59.95/ea

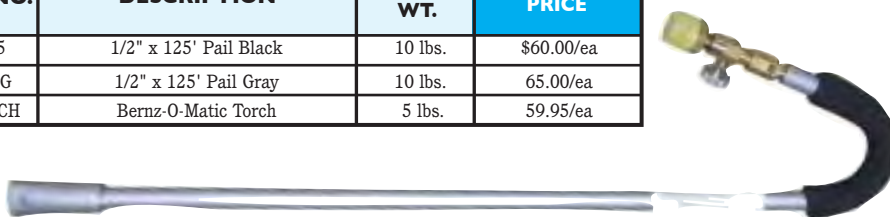

CSX900 TORCH

**For use with
CRACK•STIX**

*The high-output
outdoor torch with
a variety of uses*

- Repairing asphalt and tar
- Removing road markings

A rugged outdoor torch featuring a comfort grip handle, ergonomically balanced. Can comfortably operate continuously for an hour on a 14.1 oz. propane cylinder. (Propane Cylinder Not Included.)

Quik-Joint

**RUBBERIZED NON-TRACKING JOINT AND
CRACK SEALING TAPE FOR ASPHALT OR**



- Permanently seals by overbanding
- Easy to use – Just peel-stick-heat
- Expands and contracts with pavement
- Maintains uniform width
- Color: Black Thickness: 3/32" (.093")±
- Convenient 50-ft. rolls available in 3 width sizes – 1", 2", or 4"

Single Rolls Available



Remove release paper.

Place over joint.

Apply heat to melt and bond.

Application: Pavement must be clean, dry and free of dust. Pavement temperature should be above 40°F (pavement may be dried or surface temperature raised by first applying heat). Remove release liner, position Quik-Joint over the pavement joint/crack, and apply heat using a continuous motion with a propane torch until melting occurs.

NOTE: Quik-Joint is designed to seal joints. It is not designed to bridge large cracks. By fabricating the Quik-Joint tape to make a rope like caulk and applying heat in order to flow the material into the opening large cracks may be filled. Fill crack to surface level with the fabricated material, then proceed to overband the joint.

QUIK-JOINT is an innovative roll-out cold-applied strip sealant that creates a durable, watertight and elastic seal after being heat-bonded to the pavement surface. Its specially-blended, high-tack rubberized asphalt compound is compatible with all common pavement surfaces. Equal or better in quality, appearance, and durability to regular hot-applied sealers at a fraction of the cost. Quick and easy to apply by only one person. Saves time and money by eliminating the expense and manpower associated with hot tar kettles and related paraphernalia.

PART NO.	DESCRIPTION	SHIPPING WT.	CONTRACTOR PRICE
3QJ-1	1-Pail 16 Rolls of 1"x 50' Length	40 lbs.	\$215.00/pail
3QJ-2	1-Pail 8 Rolls of 2"x 50' Length	40 lbs.	173.00/pail
3QJ-4	1-Pail 4 Rolls of 4"x 50' Length	40 lbs.	167.00/pail

THE MA10 MELTER/APPLICATOR

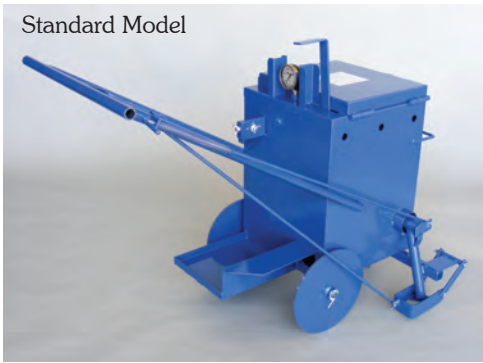

Standard Model

Length 47", Height 36", Width 27"

Up to 600 lbs. of sealant can be melted and applied per day by ONE (1) MAN with the MA-10 ...enough to seal 6400 linear feet of 1/2" X 1/2" cracks.

Suggested L-400 Rubber

A fast and efficient method for applying hot pour crack/joint sealant. Direct fire type sealant materials can be MELTED AND APPLIED by one (1) man. Or, use it to apply hot material from other larger melting equipment. Both models are mounted on steel wheels, and come equipped with hand agitators, spring loaded hand controlled release valves, steel screed for striking off the applied sealant in a neat uniform width, a burner assembly with hose and regulator, and temperature gauge, and a platform for propane bottles (propane bottle not included).

PART NO.	CAPACITY	SHIPPING WT.	CONTRACTOR PRICE
8MA10	10 gal.	160 lbs.	\$1,059.00

10, 30 or 55-GALLON MELTERS

Have direct fire type sealants ready in 30 minutes or less. All models are equipped with a hand agitator, temperature gauge, regulator, hose, burner, lifting handles, hinged lid and draw-off valve. LP cylinder not included.

Length 27"
Height 24"
Width 18"

10 Gallon
Mini Melter



Suggested L-400 Rubber



Length 40"
Height 38"
Width 29"

55 Gallon
Melter

The 30-Gal. melter
LENGTH: 49"
WIDTH: 23" HEIGHT: 37"



PART NO.	SHIPPING WT.	CONTRACTOR PRICE
8FM10	80 lbs. (10 gal.)	\$770.00
8FM30	200 lbs. (30 gal.)	1,140.00
8FM55	245 lbs. (55 gal.)	1,197.00

POUR POTS FOR CRACK SEALING

- All welded construction
- Hand-held, wheeled or crack bander models

Easy to clean, POUR POTS have large bottom openings to prevent clogging. Unique no-drip finger tip control valves. Hand-Held model is 2.6 gallon capacity with convenient stand-up legs. Wheeled model has a 2½" circular squeegee attachment. Bander is 4 gallon capacity, 3" wide band, 6" steel disc wheels, adjustable depth up to 1/8" thick.



4 Gal. Bander Machine

Pour Pot with Legs
2.6 Gal. Capacity

PART NO.	DESCRIPTION	SHIPPING WT.	CONTRACTOR PRICE
8PRPT	Pour Pot with Legs	11 lbs.	\$140.00/ea.
8PRPT-WH	4 Gal. Bander Machine	37 lbs.	466.00/ea.

THE MA10 MELTER/APPLICATOR PARTS



W11B



SS2432-24



SCR



VCR



SPRING



SCREED



TH1



TH2



THB



BURNER-6



6 HOSE



V77
NEEDLE



67CH-743



4CA



CMP



SWWB



SWIVEL



STRIKER



BURNER
W/VALVE



INNER



OUTER



TEMP10

ORIFICE



GAUGE



AXLE



SKID
ARM

Parts for 10 Gallon, 30 Gallon, and 55 Gallon Melters



GATE VALVE



TEMP10
TEMP30
TEMP55



BURNER-10



10 HOSE



¾ BRASS VALVE

MA10 OLD
VALVE



V0023200



**WE HAVE
PARTS**

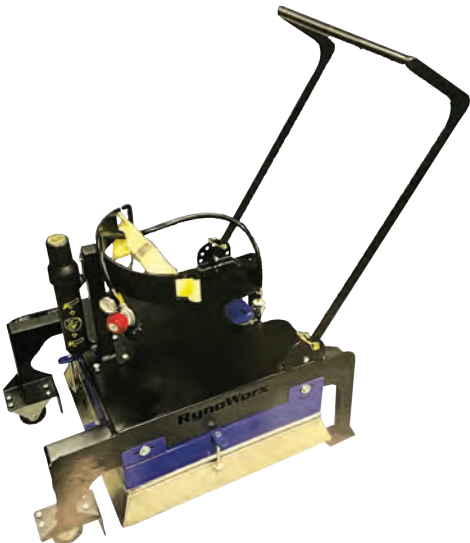

RY2X2-IR

RynoWorx Infrared Asphalt Heaters will bring distressed asphalt back to life. Infrared technology allows you to heat up and soften damaged areas so that they can be re-worked and compacted to appear brand new. In as little as 5 to 10 minutes this heater will have the asphalt brought to its original mixing temperature, allowing for effective and cost-effecient repairs. You'll now be able to spend minimal time repairing potholes, bird baths, cracks, and surface imperfections on both new and used asphalt.

PART NO.	DESCRIPTION	CONTRACTOR PRICE
8RY2X2	Mini Infared Heater	\$2,199.00





Elite Melter Applicator

The RY10MA-ELITE is the newest and most advanced melter-apppplicator available today. We built upon proven technology from earlier versions of the RY10MA-PRO but added many new features including RynoValve™, RynoDash™, Adjustable Controls as well as dozens of Major General Enhancements.

PART NO.	DESCRIPTION	CONTRACTOR PRICE
8RY10ELITE	Melter Applicator	\$2,199.00

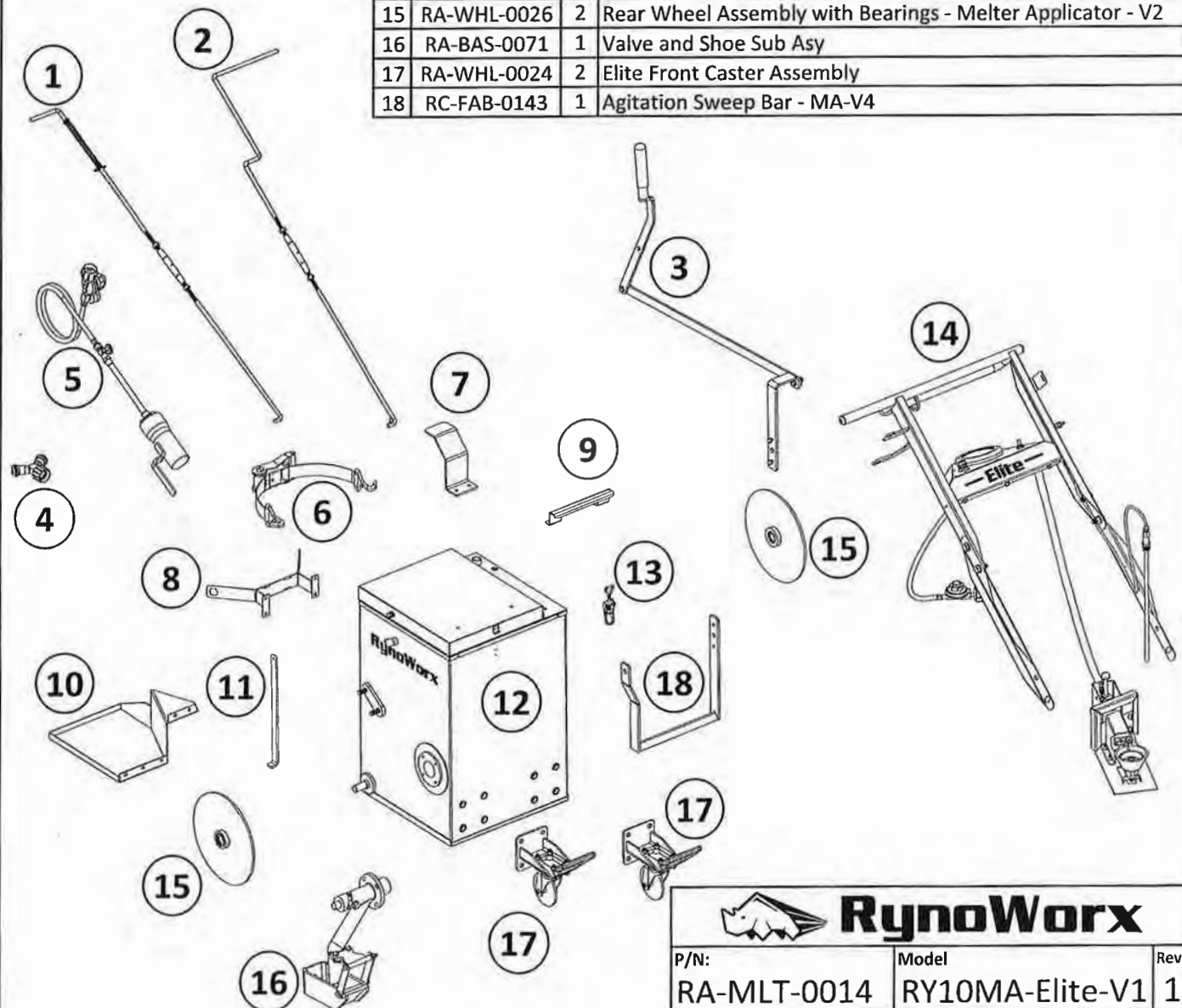
No	P/N	Qty	Description
1	RA-BAS-0059	1	Valve Control Arm Assembly - MA-V4
2	RA-BAS-0060	1	Shoe Control Arm Assembly - MA-V4
3	RA-BAS-0063	1	On-the-Fly Agitation Sub-Assembly - MA-V4
4	RC-GCM-0049	1	Propane Tank Y Splitter / Adaptor
5	RA-GCM-0015	1	MA Torch Complete Assembly
6	RC-STR-0001	1	Propane Tank Ratchet Strap
7	RC-FAB-0147	1	Thermometer Guard - MA-V4
8	RC-FAB-0133	1	Tank Spacer - MA-V4
9	RC-FAB-0151	1	Lid Handle - MA-V4
10	RC-FAB-0132	1	Tank Shelf - MA-V4
11	RC-FAB-0101	1	Melter Lid Support Slider
12	RC-FAB-0130	1	Kettle Body - MA-V4
13	RC-LCH-0001	1	Latch - 10 Gallon Kettle
14	RA-BAS-0064	1	Elite Handle Bar Assembly with Dash, Thermometer, & Burner
15	RA-WHL-0026	2	Rear Wheel Assembly with Bearings - Melter Applicator - V2
16	RA-BAS-0071	1	Valve and Shoe Sub Asy
17	RA-WHL-0024	2	Elite Front Caster Assembly
18	RC-FAB-0143	1	Agitation Sweep Bar - MA-V4



 RynoWorx		
P/N:	Model	Rev:
RA-MLT-0014	RY10MA-Elite-V1	1
Description: RY10MA-Elite - 10 Gallon Burner Fired Melter Applicator - Complete Assembly - Version 1		

"1988"

ITS
THROWBACK
TIME

GIANT V SQUEEGEES



"1988"

PART NO.	DESCRIPTION	SHIPPING WT.	CONTRACTOR PRICE
ABVPSHQ	V-Push	4 lbs.	\$32.95
ABVPULSQ	V-Pull	4 lbs.	32.50
8HNDL6TE	6' Handle	2 lbs.	6.49

ASPHALT/PAVEMENT SCRAPERS



8ASC-10
10" wide stainless steel blade SHARP
with 5" steel handle



8ASC-14
14" wide spring steel blade
FLEXIBLE with 5" steel handle

PART NO.	DESCRIPTION	SHIPPING WT.	CONTRACTOR PRICE
8ASC10	10" Scraper w/Handle	5 lbs.	\$56.00/ea.
8ASC14	14" Scraper w/Handle	6 lbs.	49.00/ea.
8ASC-R10	10" Replacement Blade	2 lbs.	26.00/ea.
8ASC-R14	14" Replacement Blade	2 lbs.	20.00/ea.

CRACK HOE

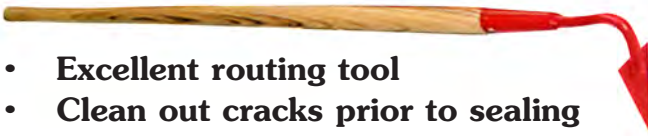

- Excellent routing tool
- Clean out cracks prior to sealing

PART NO.	DESCRIPTION	SHIPPING WT.	CONTRACTOR PRICE
8CH	2" x 4" x 10-Ga. Steel Blade w/54" Handle	3 lbs.	\$35.00/ea.



MAINTENANCE, INC.®

CELEBRATING

85 YEARS

**SERVICING OUR
VALUED CUSTOMERS**

Thank You!

CRACK FILLING SQUEEGEES

- Reversible design, push/pull
- Choose "V" Style with a 7" ferruled throat or "U" Style with a 3" throat

No more confusion about "push" or "pull" direction. Go any direction with our universal crack squeegees. Easily adjustable for "push" or "pull" action. Complete with 4-ft. wood ferruled handles.



US
Squeegee



RV
Squeegee

PART NO.	DESCRIPTION	TYPE RUBBER (Heat Limits)	SHIPPING WT.	CONTRACTOR PRICE
8RVGUM	"V" Style Squeegee	Gum-(tan) (180°F)	4 lbs.	\$55.00/ea.
8RVBK	"V" Style Squeegee	Buna-Rubber (black) (220°F)	4 lbs.	63.00/ea.
8RVRD	"V" Style Squeegee	Silicone (red) (550°F)	4 lbs.	64.00/ea.
8USNEO	"U" Style Squeegee	Neoprene (180°F)	4 lbs.	53.00/ea.
8RVRGUM	Gum Replacement Blade for "V" Squeegee		1 lb.	8.00/ea.
8RVRBK	Buna Rubber Replacement Blade for "V" Squeegee		1 lb.	9.00/ea.
8RVRRD	Silicone Replacement Blade for "V" Squeegee		1 lb.	13.50/ea.
8USR	Neoprene Replacement Blade for "U" Squeegee		1 lb.	9.00/ea.
8CSRH4	4-ft. Replacement Handle (for all crack squeegees)		2 lbs.	12.00/ea.

PREPERATION & REPAIR

Gator Patch	15
Minco Concrete Fass-Patch	15
Pothole Patch	15
Oxi-Bond	16
Tack Cote.	16
Minco Oil Spot Sealer	16

LINE STRIPING & MARKING

Fass-Stripe	17
Block Out Paint	17
Boettcher Taper	17
Giant Chalk Line Reels	18
Premarked Layout Tap Measure	18
Marking Chalk	18
Parking Lot Protractor.	18
Alphabet & Number Stencils.	19
Symbol & Kits Stencils	19-20
Wording Stencils	21
McDonald's Stencils	21
Walmart Stencils	21
Brass Stencil Kits	21
Athletic Stencil Kits	21
Individual Character Stencils	21
Parking Control Signs	22

THE "ORIGINAL" GATOR-PATCH™

- Designed especially for “Alligator Cracked” asphalt
- Less costly than hot mix skin patching

GATOR-PATCH is a ready-to-use blend of asphalt emulsion, mineral fillers, glass fiber, ground rubber and plasticizer. It is very durable for parking lots, driveways, playgrounds, walkways, running tracks, tennis courts, etc. In addition to alligator cracked areas, it can also be used to fill shallow depressions or to fill cracks in excess of 1/2” wide in asphalt surfaces.



PART NO.	DESCRIPTION	SHIPPING WT.	CONTRACTOR PRICE
3GAP5	5 Gal. Pail	57 lbs.	\$58.00/pail

Coverage: Approximately 20-50 sq. ft. per gallon at 1/4” depth. Approximately 150 linear feet per gallon for cracks 1/2” x 1/2”.

Note: Temperature must be at least 50°F and rising during application and for at least 24 hours after application. Do not apply if rain is imminent or forecast for the next 24 hours.

Application: Mix, pour on, and work in with squeegees. Prime old, oxidized surfaces with Oxi-Bond cut with water (1 part Oxi-Bond and 2 parts water).

Fill depressions over 1/4” deep in multiple applications of no more than 1/4” at a time, allowing each coat to dry thoroughly.

MINCO® CONCRETE FASS-PATCH

HIGH PERFORMANCE,
POLYMER MODIFIED,
ONE-PART CONCRETE PATCH



- Easy 1 part mix. Just add water
- Initial set in as little as 12 minutes
- Excellent freeze thaw resistance
- Excellent adhesion
- Excellent resistance to de-icers
- Open to foot traffic in as little as 2 hours
- Use for vertical, horizontal and overhead repairs

PART NO.	DESCRIPTION	SHIPPING WT.	CONTRACTOR PRICE
8MFP10	10 lb. Plastic Pail	16 lbs.	\$14.00/pail



POTHOLE PATCH

Application: Apply and compact with vehicle tire or tamper.

Coverage: 10 lbs. covers 1 sq. ft. at 1” depth.

PART NO.	DESCRIPTION	SHIPPING WT.	CONTRACTOR PRICE	
			I-62 UNITS	63 OR MORE UNITS
3PHP	50 lb. Bag	50 lbs.	\$14.00/bag	\$12.00/bag
8TAMPER-S88	8” Sq. Steel Tamper w/48” Handle	17 lbs.	118.47/ea.	
8TAMPER-S410	4” x 10” Steel Tamper w/60” Handle	17 lbs.	118.47/ea.	

OXI-BOND™

LATEX PRIMER CONCENTRATE

- To improve bonding of pavement sealers

A highly efficient easy-to-use primer for exposed aggregate or polished asphalt, old porous or oxidized surfaces, oil spots, or fresh hot mix patches. OXI-BOND PRIMER improves the performance and longevity of all pavement sealers applied over it. Make OXI-BOND PRIMER an itemized part of your bids and proposals to enhance your image, improve your jobs, and increase your profit.



PART NO.	DESCRIPTION	SHIPPING WT.	CONTRACTOR PRICE
30X5	5 Gal. Pail	48 lbs.	\$65.00/pail

Application: Dilute 50/50 with water. Apply by spray, brush, or roller.

Coverage: 180-360 sq. ft. per gallon of diluted material (.025-.05 gallon per sq. yd.)

Drying Time: 30-60 minutes for subsequent sealcoating.

TACK COTE

For paving, patching, with
asphalt - promotes adhesion

PART NO.	DESCRIPTION	SHIPPING WT.	CONTRACTOR PRICE
	5 Gal. Pail	44 lbs.	\$45.00



MINCO® OIL SPOT SEALER CONCENTRATE

- Prevents oil spot “bleeding”
- Super-concentrated, quick-drying formula saves money
- Water-based latex for ease of application and cleanup

MINCO OIL SPOT SEALER is a unique blend of copolymers and surfactants formulated in concentrate form for diluting with water prior to application. It grabs and seals oil and grease spots on asphalt surfaces to prevent “bleeding” into the cured film of pavement sealer. Prevents disbonding from the oil spot and will not allow the sealer to peel away from primed areas.

Application: Brush, roller or spray. One (1) gallon concentrate makes three (3) gallons of ready-to-use sealer/primer.

NOTE: MINCO OIL SPOT SEALER should be used over sound pavement only. If the area is so saturated that the asphalt is soft or crumbly, it should be dug out and patched with POTHOLE PATCH.

Coverage: 150-200 sq. ft. per gallon of concentrate. Drying Time: 20-30 minutes.

PART NO.	DESCRIPTION	SHIPPING WT.	CONTRACTOR PRICE
30SS5	5 Gal. Pail	48 lbs.	\$90.00/pail



FASS-STRIPE

100% ACRYLIC TRAFFIC MARKING PAINT
MEETS FED. SPEC. TT-P-1952b and TT-P-1952d

A high-performance 100% acrylic latex paint designed for professional results. Ideal for parking lots, tennis courts, walkways, curbing, etc. Formulated for non-bleeding results over freshly sealed surfaces. Add that bright finishing touch with FASS-STRIPE Paint.

Application: Brush, roller or spray.

Colors Available: White, Yellow, Handicap Blue

Coverage: 325 ft. of 4-inch line at 15 mils wet thickness

- Bright, vibrant colors
- Quick Drying
- Durable & Long Lasting
- Environmentally Friendly
100% Acrylic Water-based Formula



PART NO.	DESCRIPTION	SHIPPING WT.	CONTRACTOR PRICE
3FS5-W/Y	5 Gal. Pail White or Yellow	68 lbs.	\$130.00/pail
3FS5-BU	5 Gal. Pail Handicap Blue	68 lbs.	130.00/pail

BLOCK OUT PAINT

- Black out unwanted stripes or markings on asphalt
- Durable, water-based latex

BLOCK OUT PAINT is ready-to-use and dries fast to a tough, satin black finish.

Application: Brush, roller or spray.

Coverage: One gallon covers —
400 to 450 linear feet of 4" wide stripe
800 to 900 linear feet of 2" wide stripe

PART NO.	DESCRIPTION	SHIPPING WT.	CONTRACTOR PRICE
3BLACK5	5 Gal. Pail	48 lbs.	\$80.00/pail

BOETTCHER TAPER

- Easy, fast layout and accurate striping

The BOETTCHER TAPER is precision built to lay sharp, accurate masking lines on almost any surface. Use it for foolproof layout and striping straight lines, perfect circles (up to 12') or curves on tennis courts, basketball courts, gymnasium floors, etc. 3/4", 1" or 2" masking tape is laid smoothly, evenly, taking the risk out of painting boundary lines from 2" to 4" wide.

PART NO.	DESCRIPTION	SHIPPING WT.	CONTRACTOR PRICE
8TAPER	Tape Machine Complete	25 lbs.	\$740.00
8POLE	(Optional) 3-Point ext. pole kit w/dolly for NCAA 19'9" radius basketball 3-point line	20 lbs.	\$220.00/kit

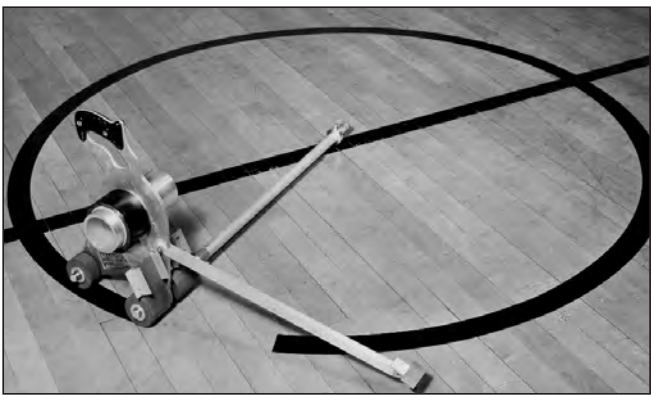

GIANT CHALK LINE REELS

FOR FREQUENT SNAPS AND BOLD LINES

1/8" Polycord String

- “Glovable” grip for cold weather or rough conditions
- Self-sealing “quick fill/no spill” grommet
- Steel crank rewind for long life
- Recessed handle clasp stores the handle out of the way
- String is cotton polycord that holds chalk until it’s snapped right where you want it. Thick 1/8 of an inch for bold lines
- Bright orange ABS case takes a beating and easy to find quickly in the clutter.



PART NO.	DESCRIPTION	SHIPPING WT.	CONTRACTOR PRICE
8GIANT	130' Chalk Line Reel	3 lbs.	\$45.00/ea.
8LGIANT	100' Chalk Line Reel	2 lbs.	\$26.00/ea.

PREMARKED LAYOUT TAPE MEASURE



5 color-coated pre-marked layouts include: 8-feet-6 inches, 9-feet-0 inches, and 10-feet-0 inches straight in parking, along with 60 degree parking of 9-feet-0 inches and 10-feet-0 inches.

- **For parking lot striping**
300-foot tough fiberglass measuring tape mounted on cord reel. Tape is pre-marked with color codes for desired straight-in or angled parking stall sizes. Helps align stall depth and width in one step.

PART NO.	DESCRIPTION	SHIPPING WT.	CONTRACTOR PRICE
8PRTAPE	Premarked Layout Tape	6 lbs.	\$225.00/ea.

MARKING CHALK

Packaged in convenient poly bottles with spout caps.



Colors available: White or Blue

PART NO.	DESCRIPTION	SHIPPING WT.	CONTRACTOR PRICE
8MC5	5 lb. Bottle Chalk(Specify Color)	6 lbs.	\$9.50/ea.



PARKING LOT PROTRACTOR

FOR FAST & ACCURATE LAYOUTS AND QUICK & EASY ANGLES

At last, a handy, practical and accurate tool for laying out parking lots in less time. Simplifies angles. Made of 1/8" ABS Plastic with a finger nut lock. 180° range with 5° increments.

Closed Height: 3' 11"
Open Height: 7' 7"

PART NO.	DESCRIPTION	SHIPPING WT.	CONTRACTOR PRICE
8PLP	Parking Lot Protractor	4 lbs.	\$48.00/ea.

POLYETHYLENE

STENCILS

FOR UNIVERSAL MARKING

- Save time and money
- Easy to clean
- Easy to transport



OVERNIGHT DELIVERY available on all in stock standard stencils

Precision cut out of a superior grade polyethylene material, these professional quality stencils make clean, sharp, and accurate pavement markings easy. Our top grade 1/8" thick (125 mil) stencils will stand up to the most rigorous day-to-day use by contractors. For economy-minded limited use needs, our 1/16" thick (60 mil) stencils will still perform well. Easy maintenance is the result of the smooth non-stick surface. Just flex and peel away dried paint.

All our character stencils are a standard GOTHIC BLOCK style/font, but we are also capable of producing letters, numbers, or words in different styles or fonts by special order (contact us for pricing). All wording stencils from 24" to 96" in height are designed around D.O.T. specifications and are designed to be read at a 22 degree angle.

ALPHABET AND NUMBER KITS

Standard Number Kit (12 Pieces): 1,2,3,4,5,6,7,8,9,0,2-blanks

Standard Alphabet Kit (28 Pieces): A through Z, 2-blanks

MegaAlphabet/Number Kit (63 Pieces): A,A,B,C,D,E,E,E,F,G,H,I,I,J,K,L, L, M,N,N,O, O,P,Q,R,R,S,S,S,T,T,U,V,W,X,Y,Z,1,1,2,2,3,3,4,4,5,5,6,6,7,7,8,8,9,0,0,0, & #/()-, and 4-blanks

A A B C D E E

PART NO.	DESCRIPTION	SHIPPING WT.		CONTRACTOR PRICE	
		1/16"	1/8"	1/16"	1/8"
8MS-8020	2" Std. Number Kit, 12 pcs.	1 lb.	2 lbs.	\$18.00	\$30.75
8MS-8025	2" Std. Alphabet Kit, 28 pcs.	2 lbs.	3 lbs.	52.00	96.50
8MS-8028	2" Mega Kit, 63 pcs.	2 lbs.	3 lbs.	81.50	148.00
8MS-8030	3" Std. Number Kit, 12 pcs.	1 lb.	2 lbs.	19.75	34.75
8MS-8035	3" Std. Alphabet Kit, 28 pcs.	3 lbs.	4 lbs.	58.00	101.25
8MS-8038	3" Mega Kit, 63 pcs.	3 lbs.	4 lbs.	92.00	161.00
8MS-8040	4" Std. Number Kit, 12 pcs.	1 lb.	2 lbs.	22.00	37.25
8MS-8045	4" Std. Alphabet Kit, 28 pcs.	2 lbs.	4 lbs.	62.50	116.50
8MS-8048	4" Mega Kit, 63 pcs.	3 lbs.	4 lbs.	98.25	178.75
8MS-8060	6" Std. Number Kit, 12 pcs.	2 lbs.	4 lbs.	38.25	65.75
8MS-8065	6" Std. Alphabet Kit, 28 pcs.	4 lbs.	6 lbs.	107.75	182.75
8MS-8068	6" Mega Kit, 63 pcs.	5 lbs.	8 lbs.	169.75	292.25
8MS-8080	8" Std. Number Kit, 12 pcs.	2 lbs.	4 lbs.	54.00	94.50
8MS-8085	8" Std. Alphabet Kit, 28 pcs.	5 lbs.	11 lbs.	152.50	251.25
8MS-8088	8" Mega Kit, 63 pcs.	6 lbs.	13 lbs.	237.25	402.50
8MS-8100	10" Std. Number Kit, 12 pcs.	4 lbs.	8 lbs.	62.00	119.00
8MS-8105	10" Std. Alphabet Kit, 28 pcs.	7 lbs.	14 lbs.	162.00	293.75
8MS-8108	10" Mega Kit, 63 pcs.	9 lbs.	18 lbs.	252.75	474.00
8MS-8120	12" Std. Number Kit, 12 pcs.	4 lbs.	8 lbs.	69.50	123.75
8MS-8125	12" Std. Alphabet Kit, 28 pcs.	9 lbs.	17 lbs.	197.00	318.25
8MS-8128	12" Mega Kit, 63 pcs.	11 lbs.	21 lbs.	310.25	512.50

Other sizes available: 18", 24", 36", 42" and 48". Phone for prices.

SYMBOLS AND KITS



PART NO.	DESCRIPTION	SHIPPING WT.		CONTRACTOR PRICE	
		1/16"	1/8"	1/16"	1/8"
8MS-0001	4' x 8' Sheet	12 lbs.	22 lbs.	\$58.25	\$108.50
8MS-0002	4' x 10' Sheet	15 lbs.	28 lbs.	88.50	133.56
8MS-1010	Standard Stencil Kit, Includes 1 ea.: MS-3021 Std. Handicap, MS-4042 Std. Arrow Kit, MS-7121 12" NO PARKING, FIRE LANE, MS-8120 12" Number Kit, MS-7041 4" NO PARKING, FIRE LANE, VISITORS, RESERVED	15 lbs.	31 lbs.	289.00	560.25
8MS-1020	Large Stencil Kit, Includes 1 ea.: MS-3039 Std. Handicap, MS-4090 Std. Arrow Kit, MS-7241 24" NO PARKING, FIRE LANE, MS-8120 12" Number Kit, MS-7041 4" NO PARKING, FIRE LANE, VISITORS, RESERVED	24 lbs.	49 lbs.	355.00	685.50
8MS-3015	Handicap Symbol Small, 15-1/2" ht. to DOT Spec. (15-1/2" x 13 3/4")	3 lbs.	4 lbs.	20.00	38.50
8MS-3021	Handicap Symbol Standard, 21-1/2" ht. to DOT Spec. (21-1/2" x 19")	3 lbs.	4 lbs.	26.00	50.50
8MS-3030	Handicap DOT Kit, 2 pcs. (1) 30" ht. H/C Symbol with a 42" sq. OD x 3" bar White Border, (1) 38" sq. Blue Background Stencil	8 lbs.	14 lbs.	75.75	148.50
8MS-3039	Handicap Symbol Large, 39" ht. to DOT Spec. (39" x 34" with 4" bars)	5 lbs.	10 lbs.	50.50	98.50
8MS-3048	Handicap Symbol CAL-Spec. 48" ht. to DOT Spec. (48" x 43 1/2" with 3" bars)	7 lbs.	12 lbs.	63.75	117.00
8MS-3072	Handicap Symbol, 2 pc., 72" ht. to DOT Spec. (72" x 63" with 5" bars)	10 lbs.	19 lbs.	85.25	165.50
8MS-3139	Stork Symbol 39" square	5 lbs.	10 lbs.	79.75	155.50
8MS-3148	Texas Handicap Symbol, 48" ht. to DOT Spec. (48" x 41 1/4" with 4" bars)	7 lbs.	12 lbs.	63.75	117.00
8MS-4042	Arrow Kit Standard, 2 pcs., 42" OAL (1) Straight Arrow, (1) Curved Arrow, (42" x 20")	4 lbs.	7 lbs.	50.50	98.50
8MS-4060	Straight Arrow (60" x 36", tail has 12" stroke)	6 lbs.	11 lbs.	63.75	117.00
8MS-4065	Arrow, Curved Tail to fit S-4060, (17" x 38" with 12" bar)	4 lbs.	7 lbs.	43.00	74.50
8MS-4090	Arrow Kit Large, 3 pcs., 90" OAL (1) Head (40" x 36") (1) Straight Tail (42" x 12") (1) Curved Tail (42" x 24")	8 lbs.	14 lbs.	75.60	148.50
8MS-5000	Highway and Intersection Straight Arrow Kit, 2 pcs., 10" OAL	12 lbs.	21 lbs.	134.50	276.25
8MS-5010	Highway and Intersection Curved Arrow Kit, 2 pcs., 8" OAL	12 lbs.	21 lbs.	145.75	292.50
8MS-5015	Highway and Intersection Combo Arrow Kit, 3 pcs., 13" OAL (1) Curved Head, (1) Straight Head, (1) Tail Section	18 lbs.	33 lbs.	235.25	472.75
8MS-5020	Railroad "R", 6'6" x 1'-1/2" to DOT Spec. (Details may vary)	4 lbs.	7 lbs.	53.50	105.50
8MS-5030	Bicycle Lane Symbol 6'6" x 3'8" to DOT Spec.	9 lbs.	16 lbs.	60.75	120.00
8MS-5035	Pedestrian Crossing Symbol 4'6" x 3'8" to DOT Spec.	6 lbs.	10 lbs.	56.00	108.75
8MS-5040	Intersection Crosswalk Bar Your choice in width Up to 24" x 7'6" long	5 lbs.	9 lbs.	45.50	90.50
8MS-5050	Wheel Stop Overspraying Kit, 2 pcs. "L" Shaped, 8" x 78" ID	3 lbs.	5 lbs.	25.25	46.80
8MS-5060	Line Stencil, 1 pc., 4" w. x 14' l. Stripe on Material 12" w. x 15' l. (Available in 1/16" only)	12 lbs.	—	61.75	—
8MS-5070	Line Loop Stencil for Double Lines	3 lbs.	4 lbs.	26.50	43.25
8MS-5080	Traffic Cone I.D. Stencil Fits 18" Cone, 1" Character	3 lbs.	—	34.75 /word	—
8MS-5082	Traffic Cone I.D. Stencil Fits 28" Cone, 1" Character	3 lbs.	—	40.25 /word	—



S-0001 D/M
4' x 8' LDPE Plastic Sheet



S-0002 D/M
4' x 10' LDPE Plastic Sheet



S-3021 D/M Standard Handicap Symbol
21-1/2" Tall x 19" Wide
To D.O.T. specs.



S-3148 D/M Handicap Symbol
48" Tall x 41-1/4" Wide x 4" Bar
To Texas D.O.T. specs.



S-4065 D/M Arrow Curved Tail
12" Wide Tail, Fits S-4060

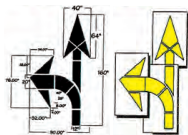

S-5015 D/M Arrow Combo Kit, 3 Pc.
Highway/Intersection
13'-4" O.A.L. to Texas D.O.T. Spec.
(Details vary per state)



S-5040 D/M Intersection Crosswalk Stop Bar
Your choice in width up to 24" x 7'-6" long inside D/Mension with a 3" bar on all sides.



S-5080 D Traffic Cone I.D. Stencil
Fits 18" cones, 1" character size
(Made In Durolast Only)



S-3030 D/M Handicap D.O.T. Kit, 2 Pc.
(1) 30" Handicap Symbol with a outside Border of 42" sq. x 3" wide bar.
(1) 38" sq. blue background stencil.



S-3072 D/M Handicap Symbol, 2 Pc.
72" Tall x 63" Wide x 5" Bar
To D.O.T. Specs.

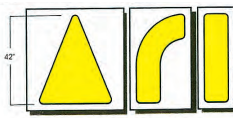

S-4090 D/M Large Arrow Kit, 3 Pc.
(1) Head, 42" Tall x 36" Wide (1) Straight Tail 42" x 12", (1) Curved Tail 42" x 24"



S-5020 D/M Railroad "R"
To Texas D.O.T. Spec.
(Details vary per state)



S-5050 D/M Wheel Stop Overspray Kit, 2 Pc.
"L" shaped 8" x 78" I.D.



S-5082 D Traffic Cone I.D. Stencil
Fits 28" cones, 1" character size
(Made In Durolast Only)

S-1020 D/M Large Stencil Kit Includes

1-each of the following
39" Handicap Symbol
90" Large Arrow Kit, 3 pc.
24" "NO PARKING"
24" "FIRE LANE"
12" Standard Number Kit, 12 pc. 4" "NO PARKING"
4" "FIRE LANE"
4" "VISITORS"
4" "RESERVED"



S-3039 D/M Handicap Symbol
39" Tall x 34" Wide x 4" Bar
To D.O.T. specs.

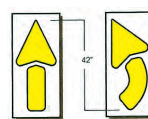

S-4042 D/M Standard Arrow Kit, 2 Pc.
(1) straight tail, (1) curved tail 42"
O.A.L. 20' Wide Head, 12" Wide Tail

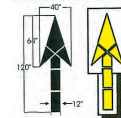

S-5000 D/M Straight Arrow Kit, 2 Pc. Highway/Intersection
10' O.A.L. To D.O.T. Spec.



S-5030 D/M Bicycle Lane Symbol
6'-6" Tall x 3'-8" Wide.
To D.O.T. Spec.



S-5060 D Line Stencil
1 pc., 4" wide x 14' long stripe
On material 12" x 15' long.
(Made In Durolast Only)



S-3139 D/M Stork Symbol
39" Tall x 39" Wide.



S-3015 D/M Handicap Symbol
1 5-1/2" Tall x 13-3/4" Wide
To D.O.T. specs.



S-3048 D/M Handicap Symbol
48" Tall x 43-1/2" Wide x 3" Bar To California D.O.T. Specs.

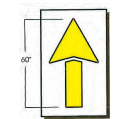

S-4060 D/M Straight Arrow
60" O.A.L. 36" Wide Head, 12" Wide Tail



S-5010 D/M Curved Arrow Kit, 2 pc. Highway/Intersection
8'-4" O.A.L. to Texas D.O.T. Spec.
(Details vary per state)



S-5035 D/M Pedestrian Crossing Symbol
4'-6" T. x 3'-8" W. To D.O.T. Spec.



S-5070 D/M Line Loop Stencil
For double lines, any width and size.

LINE STRIPING & MARKING

WORDING STENCILS

All of our characters are a standard GOTHIC BLOCK style/font, but we are also capable of producing letters, numbers or words in over 130 different styles/fonts or other languages, if necessary. All styles/fonts are generated and stored on computer files for future recall and production. All wording stencils from 24" to 42" in height are designed around DOT specifications and meant to be read at 22°.

Prices per wording up to 4, 5, 8, and 10 letters — any word available.

PART NO.	DESCRIPTION	SHIPPING WT.		CONTRACTOR PRICE	
		1/16"	1/8"	1/16"	1/8"
8MS-7021	2" Wording, 1-1/2" wide x 3/8" bar. Up to 10 Letters	1 lb.	2 lbs.	\$16.50	\$30.50
8MS-7031	3" Wording, 2" wide x 3/8" bar. Up to 10 Letters	2 lbs.	3 lbs.	19.00	36.00
8MS-7041	4" Wording, 2-1/4" wide x 1/2" bar. Up to 10 Letters	2 lbs.	3 lbs.	21.50	37.00
8MS-7061	6" Wording, 4" wide x 7/8" bar. Up to 10 Letters	2 lbs.	4 lbs.	26.00	41.25
8MS-7081	8" Wording, 6" wide x 1-1/2" bar. Up to 10 Letters	3 lbs.	5 lbs.	36.50	67.50
8MS-7101	10" Wording, 7-1/2" wide x 1-3/4" bar. Up to 10 Letters	4 lbs.	8 lbs.	41.25	80.00
8MS-7120	12" Wording, 9" wide x 2" bar. Up to 5 Letters	4 lbs.	7 lbs.	32.25	62.00
8MS-7121	12" Wording, 9" wide x 2" bar. 6 to 10 Letters	5 lbs.	9 lbs.	45.75	90.50
8MS-7180	18" Wording, 9" wide x 2" bar. Up to 5 Letters	5 lbs.	9 lbs.	38.50	72.75
8MS-7181	18" Wording, 9" wide x 2" bar. 6 to 10 Letters	6 lbs.	10 lbs.	55.50	108.75
8MS-7240	24" Wording, 9" wide x 2" bar. Up to 5 Letters	6 lbs.	11 lbs.	44.50	85.25
8MS-7241	24" Wording, 9" wide x 2" bar. 6 to 10 Letters	8 lbs.	13 lbs.	65.50	130.50
8MS-7360	36" Wording, 9" wide x 2-1/2" bar. Up to 5 Letters	7 lbs.	12 lbs.	60.75	120.25
8MS-7361	36" Wording, 9" wide x 2-1/2" bar. 6 to 10 Letters, 2 pcs.	10 lbs.	19 lbs.	90.75	177.75
8MS-7420	42" Wording, Up to 5 Letters	7 lbs.	12 lbs.	71.50	139.00
8MS-7421	42" Wording, 6 to 10 Letters, 2 pcs.	11 lbs.	20 lbs.	121.50	230.75

McDONALD STENCILS DRIVE THRU

PART NO.	DESCRIPTION	SHIPPING WT.		CONTRACTOR PRICE	
		1/16"	1/8"	1/16"	1/8"
8MCD3420	34" McDonald Word - DRIVE	6 lbs.	11 lbs.	\$60.75	\$120.00
8MCD3430	34" McDonald Word - THRU	6 lbs.	11 lbs.	\$60.75	\$120.00
8MCD3440	34" McDonald Word - THANK	6 lbs.	11 lbs.	\$60.75	\$120.00
8MCD3450	34" McDonald Word - YOU	5 lbs.	10 lbs.	\$60.75	\$120.00
8MCD4210	Arrow in Circle, 2pcs, 42"	10 lbs.	18 lbs.	\$63.75	\$117.00
8MCD3660	Stencil Kit, 6 pcs	28 lbs.	48 lbs.	\$291.50	\$568.00

WALMART STENCILS STOP

PART NO.	DESCRIPTION	SHIPPING WT.		CONTRACTOR PRICE	
		1/16"	1/8"	1/16"	1/8"
8WAL8410	84" Handicap Stencil	12 lbs.	20 lbs.	\$175.50	\$331.00
8WAL7610	76" Straight Arrow	7 lbs.	12 lbs.	\$117.00	\$225.00
8WAL6410	64" Curved Arrow	7 lbs.	12 lbs.	\$127.00	\$243.00
8WAL5410	Combo Arrow	12 lbs.	21 lbs.	\$145.75	\$292.50
8WAL3610	36" Walmart Word - ENTER	7 lbs.	12 lbs.	\$132.50	\$191.75
8WAL3620	36" Walmart Word - EXIT	7 lbs.	12 lbs.	\$132.50	\$191.75
8WAL9610	96" Walmart Word - YIELD	20 lbs.	38 lbs.	\$245.75	\$394.50
8WAL9620	96" Walmart Word - ONLY	20 lbs.	38 lbs.	\$196.75	\$380.00
8WAL9630	96" Walmart Word - STOP	20 lbs.	38 lbs.	\$196.75	\$380.00

BRASS INTERLOCKING STENCIL KITS

• Create your own wording or signs • Easy to use

92 Piece Kit Includes:

AAA,BB,CC,DD,EEEE,FF,GG,HH,III,JJ,KK,LL,MM,NNN,OOO,PP,Q,RR,SSS,TT, UU,VV,WW,XX,YY,ZZ,111,22,33,44,55,66,77,88,99,000, 1 Beginner, 1 Period Ender, 1 Plain Ender, 3 Spacers, 2 Periods, 1 Comma, 1 Dash.

15 Piece Kit Includes:

1,2,3,4,5,6,7,8,9,00, 1 Period, 1 Dash, 1 Beginner, 1 Ender.

PART NO.	DESCRIPTION	SHIPPING WT.	CONTRACTOR PRICE
8BR1	1" Brass Kit, 92 pcs.	2 lbs.	\$80.00
8BR2	2" Brass Kit, 92 pcs.	2 lbs.	120.00
8BR3	3" Brass Kit, 92 pcs.	3 lbs.	190.00
8BR4	4" Brass Kit, 92 pcs.	4 lbs.	280.00
8BR5	5" Brass Kit, 92 pcs.	6 lbs.	360.00
8BR6	6" Brass Kit, 92 pcs.	7 lbs.	420.00
8BR1-S	1" Brass Kit, 15 pcs.	2 lbs.	15.00
8BR2-S	2" Brass Kit, 15 pcs.	2 lbs.	19.00
8BR3-S	3" Brass Kit, 15 pcs.	2 lbs.	31.00
8BR4-S	4" Brass Kit, 15 pcs.	3 lbs.	45.00
8BR5-S	5" Brass Kit, 15 pcs.	5 lbs.	56.00
8BR6-S	6" Brass Kit, 15 pcs.	6 lbs.	68.00

ATHLETIC KITS 45GA

PART NO.	DESCRIPTION	SHIPPING WT.		CONTRACTOR PRICE	
		1/16"	1/8"	1/16"	1/8"
8MS-6030	Football Field Number Kit 8 pcs. Roman Style 3' tall x 2' wide G,0,1,2,3,4,5,∇	30 lbs.	54 lbs.	\$335.00	\$583.00
8MS-6060	Football Field Number Kit 8 pcs. Roman Style 6' tall x 42" wide G,0,1,2,3,4,5,∇	49 lbs.	87 lbs.	565.50	881.50
8MS-6070	Football Field Yard Dash Mark Kit 2 pcs. Hinged 5 Yard Kit Marks 4 Dashes and 1 Inbound Line	10 lbs.	18 lbs.	202.25	375.75
8MS-6100	Track Lane Marking Kit 12 pcs. Roman Style 3' tall x 2' wide, 1,2,3,4,5,6,7,8, Start Line, Hurtle, Exchange and Acceleration Marker	25 lbs.	49 lbs.	422.05	817.50
8MS-6400	Shuffleboard Kit 3 pcs., 10' long x 6' wide Built to Official National Standard Court Spec.	29 lbs.	56 lbs.	407.25	655.50
8MS-6420	Hopscotch Kit 11 pcs., 7'6" long x 2' wide 12" Squares, 6" Numbers 1 through 10	9 lbs.	16 lbs.	91.25	179.00
8MS-6425	Hopscotch Kit Dome, 9' high x 40" wide	12 lbs.	23 lbs.	122.75	233.75
8MS-6475	Basketball Kit Complete (available in 1/16" only)	19 lbs.	N/A	352.50	—

INDIVIDUAL CHARACTERS

Priced Per Character

PART NO.	DESCRIPTION	SHIPPING WT.		CONTRACTOR PRICE	
		1/16"	1/8"	1/16"	1/8"
8MS-9360	36" Characters 9" wide x 2-1/2" bar. to DOT Spec.	2 lbs.	3 lbs.	\$20.75	\$40.00
8MS-9420	42" Characters 12" wide x 2-1/2" bar. to DOT Spec.	2 lbs.	3 lbs.	24.25	46.80
8MS-9480	48" Characters 12" wide x 3" bar. to DOT Spec.	3 lbs.	5 lbs.	34.00	63.75
8MS-9720	72" Characters 16" wide x 3" bar. to DOT Spec.	4 lbs.	7 lbs.	41.25	78.25
8MS-9960	96" Characters 16" wide x 4" bar. to DOT Spec.	5 lbs.	9 lbs.	49.25	95.25

PARKING CONTROL SIGNS

Heavy-duty aluminum traffic signs feature a reflective surface for maximum visibility and pre-drilled holes for easy mounting. Available with or without 8-ft. green U-Channel Steel posts.

PART NO.	DESCRIPTION	SHIPPING WT.	CONTRACTOR PRICE
8JP1	12"x 18" Handicap Parking Sign	2 lbs.	\$28.00/ea.
8JP13	12"x 6" Van Accessible Sign	1 lbs.	19.00/ea.
8JP11	24" STOP Sign (0.80 Gauge)	5 lbs.	47.00/ea.
8JP12	8" Green U-Post	16 lbs.	28.00/ea.

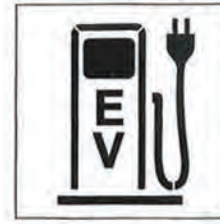

Call for Pricing 800-892-6701

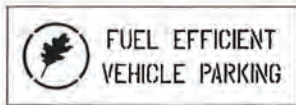

TOOLS & SUPPLIES

Lightweight Spray Wand	24	Brush/Squeegee Brush Box	29
"Original" Able Edger	24	Barricade Tape	30
Spray Wand Material Hose	24	Tyvex Disposable Spray Pants	30
Brass Spray Wand Ball Valve	24	Coveralls	30
"Goliath" Asphalt Lute	25	Traffic Cones	30
Heavy-Duty Hand Tampers	25	Flourescent Flagging Tape	30
Asphalt Shovels	25	Billy Goat Blowers	31
Drum Gate Valves	25	Billy Goat Crevice Cleaner	31
Felt Asphalt	25	Little Wonder Optimax Blower	32
Brush Strips/holders/handles	26	Little Wonder C5 Blower	32
Applicator Brush	26	Little Wonder Pro Crack Cleaner	32
Steel Frame Neoprene Sealer Squeegee	26	Plastic Parking Stops	33
Blacktop Squeegee Brush/Brush	26		
Blacktop Applicator Brush	26		
Aluminum Extrusion-Type Squeegee	27		
Steel Frame Neoprene Sealer Squeegee	27		
Drill Mixer Impeller	27		
Trim Brush with Handle	27		
Pro-Coater - Gum Rubber Squeegee	27		
Professional Street Brooms	28		
Oil-Flo Cleaner & De-Greaser	28		
Oil Spot Broom	28		
Water Meter Shut-Off Valve	28		
Measuring Wheels	29		

RECREATIONAL SURFACING

Color Coat	34
Boettcher Taper	34
Acrylinc Resurfacer	35
Acrylic Binder	35
Acrylic Primer	35
Acrylic Pourable Crack Filler	36
Acrylic Trowel Grade Filler	36
Tennis Court Line Paint	36

EZ GRIP LIGHTWEIGHT SPRAY WAND

THE ULTIMATE SPRAY WAND FOR SEALCOATING

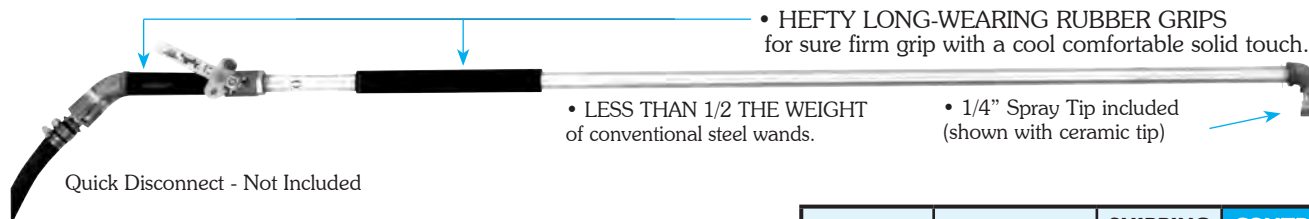

PART NO.	DESCRIPTION	SHIPPING WT.	CONTRACTOR PRICE
8LWSW	EZ Grip Lightweight Spray Wand	8 lbs.	\$98.00/ea
8SWQD	3/4" Spray Wand Quick Disconnect		\$25.00

The "Original" Able Edger

- 14 gauge lightweight aluminum shield for cutting in edges with no overspray
- Flexible rubber squeegee for uniform edging and smoothing overspray
- A real time saver
- One man operation

PART NO.	DESCRIPTION	SHIPPING WT.	CONTRACTOR PRICE
80AE	EDGER	14 lbs.	\$194.00
80AEB	Able Edger Blades Set of 2	3 lbs.	\$12.00/set

The Edger, a light weight aluminum shield, designed to reduce your cut-in time, is easily attached to a spray wand. Once attached, spraying along curbs, buildings, and fencing is quickly done and the texture of the sealcoating material is uniform at the edges as well as the center of the job.

The Edger is one of the most time saving tools ever introduced to the sealcoating industry. It will pay for itself in less than 10,000 linear feet of edging in time saved.



HARDENED STEEL SPRAY TIPS

Precision machined to the closest tolerances in the industry. The orifice is checked with a pin gauge. Free of nicks and burrs that can affect spray patterns. They are hardened to 60-65 Rockwell. Available thread sizes are 1/4", 3/8", and 1/2". Available orifice sizes are 80/20 (1/4" only), 80/30, 80/40, 80/50, 80/70, and 80/100. (80-degree fan spray)

PART NO.	DESCRIPTION	CONTRACTOR PRICE
8STA-L	1/4" Hardened Steel Tip (Specify Size: 80/20; 80/30; 80/40; 80/50; 80/70; 80/100)	\$3.75
8STA-LM	3/8" Hardened Steel Tip (Specify Size: 80/30; 80/40; 80/50; 80/70; 80/100)	4.00
8STA-LL	1/2" Hardened Steel Tip (Specify Size: 80/30; 80/40; 80/50; 80/70; 80/100)	5.00

Available orifice sizes:
80/20 (1/4" ONLY)
80/30 80/70
80/40 80/100
80/50

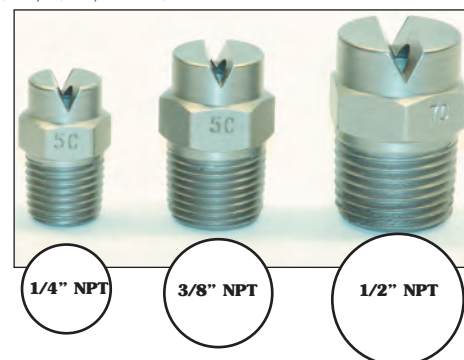

SPRAY WAND MATERIAL HOSE

High performance reinforced Goodyear 3/4" red 250 psi PLIOVIC hose. Cut length sizes include stainless hose clamps.



PART NO.	DESCRIPTION	SHIPPING WT.	CONTRACTOR PRICE
8HOSE	Spray Wand Material Hose	22 lbs./cwf	50 ft. Roll \$91.00 75 ft. Roll \$136.50 100 ft. Roll \$182.00

BRASS SPRAY WAND BALL VALVE



PART NO.	DESCRIPTION	CONTRACTOR PRICE
8LWSW/A	3/4" Ball Valve	\$35.00



THE “GOLIATH”
ASPHALT LUTE
It’s all in the bracing

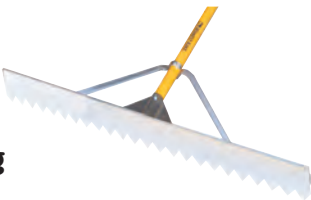

The “Goliath” lute has no competition...the strongest and most durable lute on the market. When a **superior wrap-around brace** is combined with the “original” **gusseted handle-to-head connection**... when a special recipe of aluminum and magnesium is extruded in thicker walls and head widths of 30", 36", and 42". When the handles are 82" of powder-coated aluminum **and now 1-3/8" in diameter**...well, you’ve got a lute for those who make their living using one... and it’s all American made, too.

PART NO.	DESCRIPTION	SHIPPING WT.	CONTRACTOR PRICE
8GAL30	30" Goliath Lute w/82" Handle	6 lbs.	\$77.94/ea.
8GAL36	36" Goliath Lute w/82" Handle	6 lbs.	74.38/ea.
8GAL42	42" Goliath Lute w/82" Handle	6 lbs.	80.35/ea.
8AL82H	82" Replacement Handle	2 lbs.	30.00

ASPHALT SHOVELS

Here’s the true “asphalt” shovel. Not a full size scoop and not a traditional shovel - just the perfect combination of the two. Once called “coal shovels”, these have 16-gauge oversized steel heads with “scoop-like” side edges to prevent the loss of material. More controllable than a full-sized scoop. Both come with hardwood handles in either a 36" D-handle style, or a 42" long handled style. Traditionally called Asphalt Shovels, but if you are also moving stone, dirt, mulch, or snow...these just may be the perfect size and style. Buy by the 6-pack bundle and save.



PART NO.	DESCRIPTION	SHIPPING WT.	CONTRACTOR PRICE
8AS1	Shovel w/ 36" D Handle	6 lbs.	\$39.00
8AS2	Shovel w/ 42" D Handle	6 lbs.	35.00

FELT ASPHALT



Tamp and compact where power and hand rollers can’t reach. Made with heavy gauge galvanized steel and a durable custom-blended extra-thick felt sole for long wear and clean, neat foot compaction. A no-hassle quick-release strap system allows quick in-and-out use.

PART NO.	DESCRIPTION	SHIPPING WT.	CONTRACTOR PRICE
8FAS	Felt Asphalt Shoes	4 lbs.	\$66.00/pair

HEAVY-DUTY
HAND TAMPERS

- Heavy-Duty solid all welded steel construction models
- 8" x 8" x 3/8" steel tamp with 48" double-dipped vinyl grip handle
- An EXCLUSIVE 4" x 10" Trench & Curb tamp with 60" vinyl grip handle

12" Double Dipped
Vinyl Grips

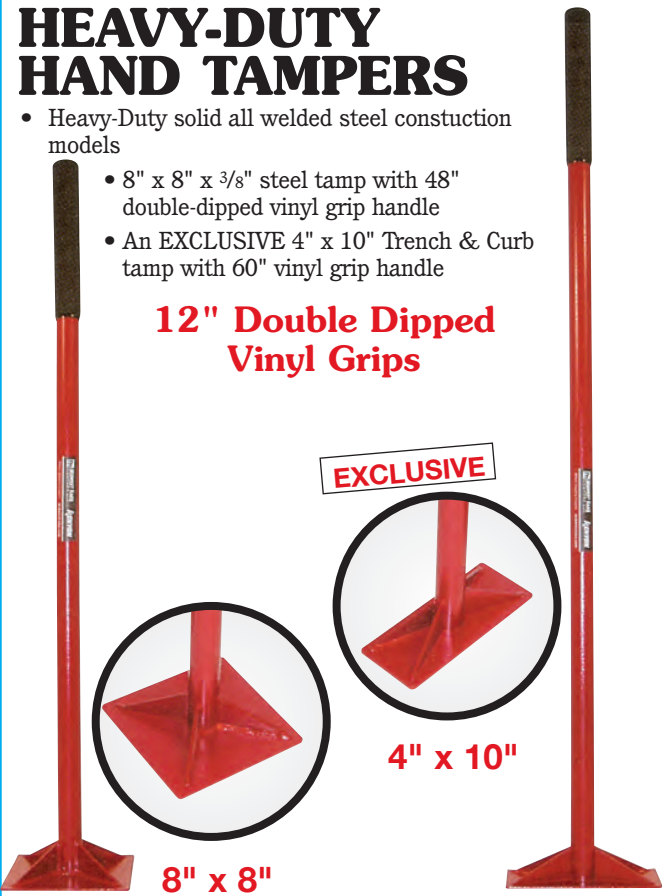

PART NO.	DESCRIPTION	SHIPPING WT.	CONTRACTOR PRICE
8TAMPER-S88	8" Sq. Steel Tamper w/ 48" Handle	17 lbs.	\$118.47
8TAMPER-S410	4" x 10" Steel Tamper w/ 60" Handle	17 lbs.	118.47

DRUM GATE VALVES
Molasses Gate

For dispensing liquids (especially viscous, slow-flowing materials) from drums. Cast iron bodies, brass sliding plates, choice of long or short handle models. Fits into standard 2" threaded fitting of most steel or fiber drums. Stays open until shut off. Can be padlocked. Not for flammables.

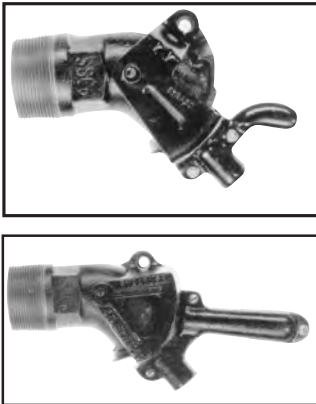

PART NO.	DESCRIPTION	SHIPPING WT.	CONTRACTOR PRICE
8GATE	2" Drum Gate w/short Handle	4 lbs.	\$85.00/ea.
8FMGATE2	2" Drum Gate w/long Handle	5 lbs.	85.00/ea.

BRUSH STRIPS, HOLDERS, HANDLES

PROFESSIONAL, HEAVY-DUTY, METAL BACKED BRUSH APPLICATORS

Full 2-1/2" crimped, black, prostran filled, rugged and durable BRUSH APPLICATORS for sealcoating applications. Use BRUSH STRIPS with unique 6-1/2" or 10-1/2" long, dual purpose HEAVY-DUTY BRUSH HOLDERS. Mount 6' WOOD HANDLES for HEAVY-DUTY HOLDERS on top for push/pull. Mount on side for pull only. All in stock for immediate shipment.

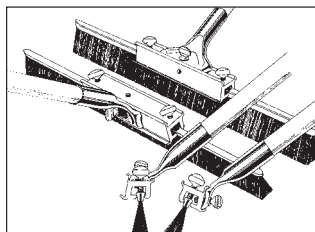

Unique dual purpose heavy-duty holder — mount handle on top for push/pull. Mount on side for pull only. 6-1/2" long or 10-1/2".

PART NO.	DESCRIPTION	SHIPPING WT.	CONTRACTOR PRICE	
			EACH	CASE OF 12
8BRSTRP24	24" Brush Strip	2 lbs.	\$11.00	\$130.00
8BRSTRP30	30" Brush Strip	2 lbs.	11.99	141.00
8BRSTRP36	36" Brush Strip	2 lbs.	12.99	169.00
8HLDRHD	6-1/2" Heavy-Duty Brush Holder	1 lb.	13.50/ea.	
8HLDRHD-L	10-1/2" Heavy-Duty Brush Holder (Recommended for 36" and 48" brush strips)	1 lb.	14.50/ea.	
8HNDL6HD	6' Wood Handle for Heavy-Duty Holder	2 lbs.	14.50/ea.	

APPLICATOR BRUSH

WOOD BLOCK NYLON FILLED SEALER BROOMS

Designed for the professional applicator. Maple wood block filled with 120 rows of nylon tufts. 30" long. Complete with handle socket. Order tapered end wood handles separately.



PART NO.	DESCRIPTION	SHIPPING WT.	CONTRACTOR PRICE	
			EACH	CASE OF 6
8SBW	Applicator Brush	3 lbs.	\$40.00	\$238.00
8HNDL6TE	6' Tapered End Wood Handle	2 lbs.	8.49	48.00

BLACKTOP SQUEEGEE/BRUSH

18" cream color polypropylene filled brush (2" trim) and squeegee combination for fast and economical application of driveway sealer. First brush the sealer on then use the squeegee to spread excess sealer to next untreated area. Includes 4' wood handle.



PART NO.	DESCRIPTION	SHIPPING WT.	CONTRACTOR PRICE	
			EACH	CASE OF 12
8DOAC	18" Brush/Squeegee Comb. Applicator w/4' Handle	3 lbs. 24 lbs. per dozen	\$14.00	\$166.00

STEEL FRAME NEOPRENE SEALER SQUEEGEES

- 5/16" x 3" extruded rubber blades (order handles separately)



PART NO.	DESCRIPTION	SHIPPING WT.	CONTRACTOR PRICE	
			EACH	CASE OF 6
8SQ24TE	Neoprene 24" Squeegee	5 lbs.	\$39.00	\$231.00
8SQ30TE	Neoprene 30" Squeegee	6 lbs.	44.00	262.00
8SQ36TE	Neoprene 36" Squeegee	7 lbs.	49.00	292.00
8HNDL6TE	6' Wood Handle	2 lbs.	8.49/ea.	
8SKTE	Extra Handle Socket w/Fasteners	—	12.00/ea.	

BLACKTOP APPLICATOR BRUSH

- Wood backed
- Cream color polypropylene filled

Trim Length: 2". One threaded handle hole.



PART NO.	DESCRIPTION	SHIPPING WT.	CONTRACTOR PRICE	
			EACH	PER DOZEN
8SAB24	24"	4 lbs.	\$25.00	\$298.00
8SAB	36"	6 lbs.	28.00	334.00

Note: Prices include brush complete with 6' metal threaded handle and handle brace.

LITE-WEIGHT ALUMINUM
EXTRUSION-TYPE
SQUEEGEES



- Mark-free, uniform finish
- Soft or firm action

Features include a radius edge molded into the blade which eliminates a break-in period and provides a mark-free finish. Adjustable notched slots allow blade to be moved for soft or firm action. Extruded neoprene blades are 1/4" x 3". Replacement blades and handles are available.

All aluminum handles are now powder coated a brilliant yellow gloss to prevent black buildup on hands and clothes.

PART NO.	DESCRIPTION	SHIPPING WT.	CONTRACTOR PRICE	REFILLS
8SQS24LW	24" Squeegee w/ 6' Alum. Handle	6 lbs.	\$69.00	\$19.00
8SQS30LW	30" Squeegee w/ 6' Alum. Handle	7 lbs.	73.00	23.00
8SQS36LW	36" Squeegee w/ 6' Alum. Handle	7 lbs.	76.00	28.00
8SQS48LW	48" Squeegee w/ 6' Alum. Handle	9 lbs.	92.00	38.00

STEEL FRAME NEOPRENE
SEALER
SQUEEGEES



- 5/16" x 3" extruded rubber blades (order handles separately)

PART NO.	DESCRIPTION	SHIPPING WT.	CONTRACTOR PRICE	
			EACH	CASE OF 6
8SQ24TE	Neoprene 24" Squeegee	5 lbs.	\$39.00	\$231.00
8SQ30TE	Neoprene 30" Squeegee	6 lbs.	44.00	262.00
8SQ36TE	Neoprene 36" Squeegee	7 lbs.	49.00	292.00
8HNDL6TE	6' Wood Handle	2 lbs.	8.49/ea.	
8SKTTE	Extra Handle Socket w/Fasteners	—	12.00/ea.	

DRILL MIXER IMPELLER

- Quick, thorough liquid mixing in 55 gallon drums

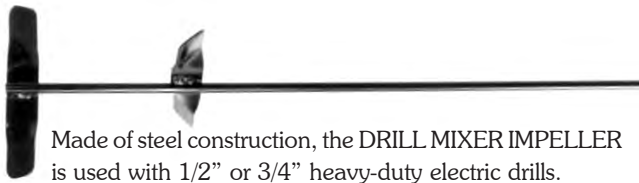

Made of steel construction, the DRILL MIXER IMPELLER is used with 1/2" or 3/4" heavy-duty electric drills.

PART NO.	DESCRIPTION	SHIPPING WT.	CONTRACTOR PRICE
8DRILL	Drill Mixer	6 lbs.	\$35.00/ea

TRIM BRUSH WITH HANDLE

7" long white tampico filled hardwood block with threaded hole. Takes 5' metal threaded hardwood handle (not included).

PART NO.	DESCRIPTION	CONTRACTOR PRICE	
		EACH	PER DOZEN
8TRIM	7" Trim Brush	\$8.00/ea.	\$94.00/doz.
8TRIMH	5' Metal Threaded Hardwood Handle	6.50/ea.	76.00/doz.



PRO-COATER®
GUM RUBBER SQUEEGEE

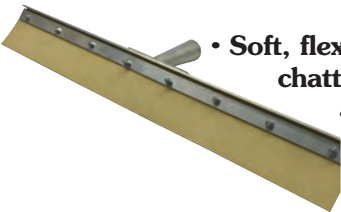

- Soft, flexible, long-wearing, chatter free
- Unique pre-worn edge

PART NO.	DESCRIPTION	SHIPPING WT.	CONTRACTOR PRICE	
			EACH	CASE OF 6
8SQPR024	24" Pro-Coater Squeegee w/o Handle	3 lbs.	\$64.00	\$382.00
8SQPR030	30" Pro-Coater Squeegee w/o Handle	6 lbs.	77.00	460.00
8SQPR036	36" Pro-Coater Squeegee w/o Handle	7 lbs.	84.00	502.00
8RFLPR24	24" Replacement Pro-Coater Blade	1 lb.	44.00/ea.	
8RFLPR030	30" Replacement Pro-Coater Blade	1 lb.	50.00/ea.	
8RFLPR036	36" Replacement Pro-Coater Blade	1 lb.	60.00/ea.	
8HNDL6TE	6' Handle	2 lbs.	8.49/ea.	

PROFESSIONAL STREET BROOMS

CLEAN THE TOUGH STUFF OFF ASPHALT OR CONCRETE



AH-6 Aluminum Handle w/Adapter Kit
Shown With 8WB16 Steel Wire Broom



No. 8WB16 Steel Wire
Street Broom

Choose from two (2) popular styles. The 16" CARBON STEEL WIRE STREET BROOM is round carbon steel wire staple set in a smooth sanded hardwood block with two tapered handle holes. Wide flare on ends allows close sweeping next to building or curbing. Trim length 3-3/4". Order handle separately. The 16" PALMYRA Stalk Street Broom has a full 6-1/4" trim length fill of very coarse stiff long-lasting material that can tackle the heaviest buildups with ease. Wide flare ends allows close sweeping to curbs or buildings. Two tapered handle holes. Order handle separately.

PALMYRA STALK is a very coarse fill material having the appearance of split bamboo. This stiff long-lasting material is used almost exclusively in street brooms for contractors and public works departments.

Tired of broken broom handles?

You need Aluminum Handle with Adapter Kit for Street Brooms. Easily attaches to broom block. Can be used over and over. Could be the last handle you'll ever buy for street brooms. Kit includes 1-1/4" x 6" powder-coated yellow aluminum handle, with mounting base and hardware.

PART NO.	DESCRIPTION	SHIPPING WT.	CONTRACTOR PRICE
8WB16	16" Carbon Steel Wire Street Broom	4 lbs. each 20 lbs. case of 6	\$29.00/ea. 174.00/(6)
8PS16	16" Palmyra Stalk, Street Broom	4 lbs. each 19 lbs. case of 6	31.00/ea. 184.00/(6)
8HNDL5TE	5' Tapered End Wood Handle for Street Broom	2 lbs.	6.00/ea.

OIL-FLO™ CLEANER AND DE-GREASER

OIL-FLO SAFETY SOLVENT is such a versatile, effective cleaner, you'll wonder how you got along without it. Very economical and easy to apply, it contains no chlorinated hydrocarbons and comes ready to use. It is non-foaming with slow evaporation. Remove tar or asphalt from just about anything. Remove grease and oil from concrete. Dissolve gasoline or hydraulic oil spills. Clean exhaust soot off vehicles. Remove old decals and stickers. Clean safety cones of oil, tire marks, asphalt, etc.

Application: Spray it on using the handy trigger spray bottle. Work it in or agitate with a brush. Rinse with cold water. Excellent for use on concrete, wood, metal, painted surfaces, glass, masonry, carpet, fabrics.

- Amazing "Sealer Cleaner" for removing tar and asphalt
- Water soluble, non-caustic



PART NO.	DESCRIPTION	SHIPPING WT.	CONTRACTOR PRICE
30F1	1 Gal. Bottles	9 lbs.	\$60.00/gal

OIL SPOT BROOM

5" long x 1/16" wide flat steel bristles staple set in 12" long x 2 3/8" wide hardwood block, use standard tapered wood handle sold separately.

PART NO.	DESCRIPTION	SHIPPING WT.	CONTRACTOR PRICE
8OSB	12" Oil Spot Broom w/o handle	3 lbs.	\$38.00/ea.
8HNDL5TE	5' Tapered end wood handle	2 lbs.	6.00/ea.



WATER METER SHUT-OFF VALVE



ELIMINATE "GUESS WORK" OR "EYE BALLING." STREAMLINE YOUR BATCH MIXES WITH ACCURATE DILUTIONS

You know what happens when too much or too little water goes into your mixes – TROUBLE. Hookup this volumetric shut-off valve to your water supply line. Dial up the gallons you want, and the flow will be metered and automatically shut off. Saves time and money.

Corrosion resistant materials ensure long trouble free service and accuracy.

PART NO.	DESCRIPTION	SHIPPING WT.	CONTRACTOR PRICE
8WMSO	Volumetric Shut-Off Valve	3 lbs.	\$152.00/ea.



MEASURING WHEELS

- *Easy, fast, accurate way to measure as you walk*



Professional quality measuring wheel instruments for virtually all needs, outdoors or indoors. Measure by yourself.

PART NO.	DESCRIPTION	SHIPPING WT.	CONTRACTOR PRICE
8MM300	Keson - Model 401 Professional Model All steel construction – 5 digitratchet counter records feet up to 100,000 feet. Wheel is 3' Circ. 11-1/4" Dia. Folding lift & lock Handle Safety-Glo color	5 lbs.	\$165.00 ea.
8MM12	Keson - Model RR112 Commercial Model Light & Compact – fits in briefcase Molded plastic counter records feet & inches up to 10,000 feet. Wheel is 1' Circ. 4" Dia. Telescoping Handle	2 lbs.	45.00

BRUSH/SQUEEGEE BRUSH BOX

- *Rugged 14 gauge steel tank with drain*
- *Redesigned lid with splash free, anti-flex technology*
- *Lid has sturdy 4" steel bullet hinges with brass bushings and pins*
- *Lid stop for hinge protection*
- *Square tubing tool holder with convenient tool access*
- *Rear opening door for convenient tool access*
- *1 1/2" raised screen bottom to protect tools*
- *40"L x 10"W x 19"D*

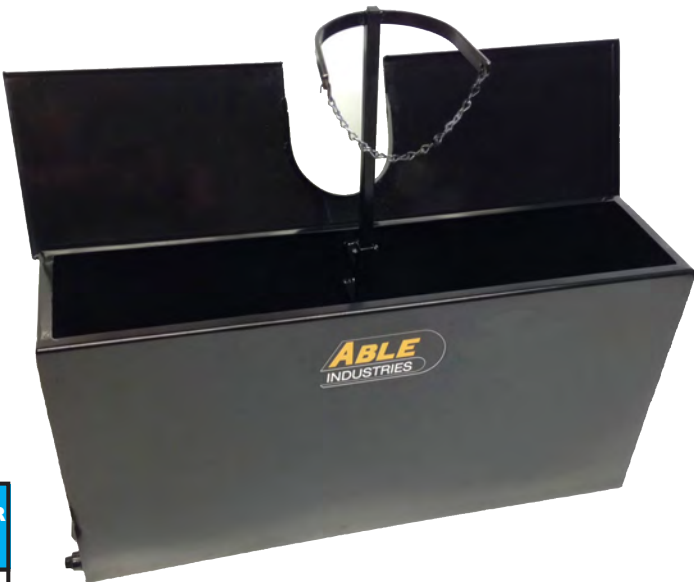

PART NO.	DESCRIPTION	SHIPPING WT.	CONTRACTOR PRICE
8AB	Able Heavy Duty Brush Box	70 lbs.	\$365.00/ea

BARRICADE TAPE

BRIGHT YELLOW

- The easy cost-effective way to block off areas to keep out people & vehicles
- 3" x 1000' roll legend: **CAUTION DO NOT ENTER**

Tough, no tear YELLOW vinyl tape with BLACK imprint. Can be tied, stapled or nailed in place. Economical to use. Professional looking. Effective.



PART NO.	DESCRIPTION	SHIPPING WT.	CONTRACTOR PRICE
8BAR	3" x 1000' Roll Barricade Tape	5 lb.	\$12.95/roll

TYVEK DISPOSABLE SPRAY PANTS

w/elastic waist

Keep that neat professional appearance with these lightweight and disposable spray pants. Economical to use. Saves on clothing costs.



PART NO.	DESCRIPTION	CONTRACTOR PRICE
8SPXL	Spray Pant size XL (150-220 lbs.)	\$6.00/each \$120.00/case of 24
8SPXXL	Spray Pant size XXL (180-250 lbs.)	\$6.00/each \$120.00/case of 24

(other sizes available by special order in min. case qty. of 50)

COVERALLS



- REFLEX design
- Lightweight and breathable
- Strong and abrasion-resistant for extended wear
- Seamless front provides more protection in the primary exposure area
- Packaged 12/each per case

PART NO.	DESCRIPTION	SHIPPING WT.	CONTRACTOR PRICE
8KGCXL	Coveralls (XL)	5 lbs.	\$84.00/cs of 12
8KGCXXL	Coveralls (XXL)	5 lbs.	\$84.00/cs of 12

TRAFFIC CONES

- Direct traffic away from work areas

100% PVC injection molded cones are a one piece design. Brilliant fluorescent red orange color throughout. Easy stacking design.



PART NO.	DESCRIPTION	SHIPPING WT.	CONTRACTOR PRICE
8CONE18	18" Cones (Case of 10)	39 lbs.	\$97.00/case



FLUORESCENT FLAGGING TAPE

Ultra-high visibility. Glo-orange plastic weather-proof colorfast type. Rolls are 150' long and 1-3/16" wide. Packed 12 rolls per case.

PART NO.	DESCRIPTION	SHIPPING WT.	CONTRACTOR PRICE
8FLAG	Flagging Tape	2 lbs.	\$29.00/case of 12



BILLY GOAT BLOWERS

THE FIRST CHOICE OF PAVEMENT PROS

Billy Goat 'FORCE' blowers are the only full line of composite blowers on the market. Choose from 6HP through 18HP models, all featuring 15 & 16 blade computer designed composite fans matched to composite volute housings for the best in class air velocity, unit weight, and dba rating. All units feature the patented "aim-n-shoot" feature for directing and fanning air output from the operator position, as well as industry-first thick padded ergonomic handles.



PART NO.	DESCRIPTION	SHIPPING WT.	CONTRACTOR PRICE
8F902H	9HP Honda Force Blower	161 lbs.	Call for Price
8F1302H	13HP Honda Force Blower	163 lbs.	Call for Price
8F1802V	18HP B&S Force Blower	186 lbs.	Call for Price



CREVICE CLEANER

by Billy Goat

VEGETATION/CRACK CLEANER

- Asphalt crevice cleaner
- Quick off the line, hugs the curves and really chews up the road

Utilizes a steel-bristled brush for scraping crevices clean • Single person operation • Rotating front caster for superior maneuverability along twisting and winding crevices • 17" wide rear platform and 8" pneumatic tires • Automatic clutch safely disengages steel-bristled cleaning wheel • Oil level alert shut-off system.

PART NO.	DESCRIPTION	SHIPPING WT.	CONTRACTOR PRICE
8GZ401H	5.0 HP Grazor Crack Chaser (Briggs)	91 lbs.	Call for Price
8GZ400WW	8" Heavy-Duty Wire Wheel for Grazor	4 lbs.	50.00/ea



Replacement Wire Wheel Brush

Solid steel wire bristles, specifically designed to sweep through crevices for a better sealing edge. 8" diameter wire brush wheel with 5/8" arbor.

8GZ400WW



**LITTLE
WONDER®**

OPTIMAX™ BLOWER

**MOVES LEAVES, DEBRIS,
STANDING WATER AND MORE...
FARTHER AND FASTER**

PART NO.	DESCRIPTION	SHIPPING WT.	CONTRACTOR PRICE
8LWOB	Optimax Blower (Honda)	170 lbs.	Call for Price
8LWC5	C5 Blower	170 lbs.	Call for Price

C5 BLOWER

- A lighter unit that packs big air power
- Aim Rite™ discharge nozzle controls air direction with tool-free adjustment
- Professional grade Subaru® engine
- Adjustable fold-down handle with padded grips
- Large rear wheels tackle curbs with ease

LITTLE WONDER® PRO CRACK CLEANER



Our Pro Crack Cleaner powers through the toughest debris quickly preparing surface cracks for sealing and expansion joints for recaulking.

PART NO.	DESCRIPTION	SHIPPING WT.	CONTRACTOR PRICE
8LWCC	Pro Crack Cleaner (Honda)	120 lbs.	Call for Price
8LWCCWW	9" Repl. Wire Wheel	4 lbs.	\$59.95/ea.



- **Adjustable front wheels** — Allow brush to stay down and keep clearing on uneven surfaces
- **Dual belt drive** — Provides added power and more grip to minimize slippage
- **Convenient belt release lever** — Enables unit to idle without added belt wear
- **Red Brush** — For edger
- **Long lasting wire wheel** — Heavy duty 9" wire wheel ensures professional, quality crack cleaning
- **Four-wheel design** — Provides extra stability and eliminates the need for a curb wheel. All wheels have steel hubs with ball bearings and full axles for smooth and easy maneuverability.



PLASTIC PARKING STOPS
(WHEEL STOPS)

The perfect low-cost alternative to concrete wheel stops. Molded of high-impact recycled thermoplastic for superior strength and durability. Easy to install with rebar fasteners. Easy to maintain — never damaged by road salts, won't chip, crack, or deteriorate from weather. Never needs painting. Protective profile design prevents front end baffle damage on today's lower built cars. CHOICE OF COLORS: Yellow or Blue.

Easy Rider Rubber Speed Bumps

100% Recycled rubber speed bumps are ideal for speed control on parking lots, driveways, etc. Will not warp, crack, chip, or rot. Black in color with high visibility yellow polyurethane glass beaded paint with built in reflectors for added safety. Install on asphalt with 14" capped rebar spikes.

Park-It Rubber Parking Stops

100% Recycled rubber parking stops ideal for effective delineation of parking or protection of walls in parking lots or garages. Black in color with high visibility yellow polyurethane glass beaded paint. Install on asphalt with 14" capped rebar spikes.

Handicap Blue
Available



PART NO.	DESCRIPTION	SHIPPING WT.	D/MENSIONS W x H x L	CONTRACTOR PRICE
8PB	6' Plastic Parking Stop w/Fasteners (specify color)	37 lbs.	6" x 4" x 72"	\$70.00/ea.
8ER6	Easy Rider Rubber Speed Bump	54 lbs.	2-1/4" x 12" x 72"	\$195.00/ea.
8PI6	Park-It Rubber Parking Stops	34 lbs.	4" x 6" x 72"	\$70.00/ea.
8ERSP	14" Rebar Spike			\$3.00/ea.



Join us by becoming a

MAINTENANCE INC DISTRIBUTOR



Carry a full line of Maintenance Inc products.
Tested and Trusted by the pavement professionals since 1938.
Select areas available.
Call us to get started 1-800-892-6701





COLOR COAT



Description:

REC-TECH Color Coat is an attractive, non-fading color coating for asphalt and concrete sport surfaces. Formulated with 100% acrylic resins, it provides a durable, weather-resistant finish with beautiful color and uniform texture. This coating remains flexible and provides predictable ball bounce, a cooler, non-glare surface, and is easy to clean.

COLOR COAT is designed for onsite mixing with silica sand and water.

Coverage:

Coverage is approximately .05 to .07 gallons per square yard, per coat. Coverage is based on undiluted gallons of Color Coat and will vary according to the porosity and texture of the surface.

Mixing Directions

Color Coat 55 Gallons
Water 28-33 Gallons
Silica Sand 400 Lbs. (70-90 Mesh AFS)

Available Colors:

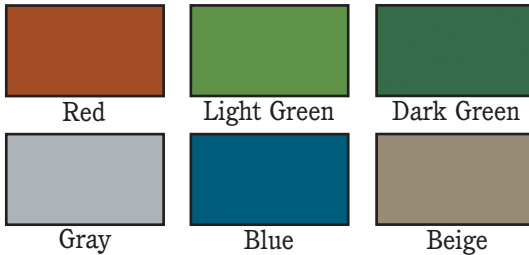

*These printed colors may vary from actual product colors.

NOTE:

Temperature must be at least 50°F and rising during application and for at least 24 hours after application. Do not apply if rain is imminent or forecast for the next 24 hours.

PART NO.	DESCRIPTION	SHIPPING WT.	Color	CONTRACTOR PRICE
3RTCC5	5 Gal. Pail	48 lbs.		\$88.00
				88.00
				88.00
				88.00
				88.00
				93.80
3RTC55	55 Gal. Drum	570 lbs.		\$901.00
				901.00
				901.00
				901.00
				901.00
				952.00

BOETTCHER TAPER

• Easy, fast layout and accurate striping

The BOETTCHER TAPER is precision built to lay sharp, accurate masking lines on almost any surface. Use it for foolproof layout and striping straight lines, perfect circles (up to 12') or curves on tennis courts, basketball courts, gymnasium floors, etc. 3/4", 1" or 2" masking tape is laid smoothly, evenly, taking the risk out of painting boundary lines from 2" to 4" wide.

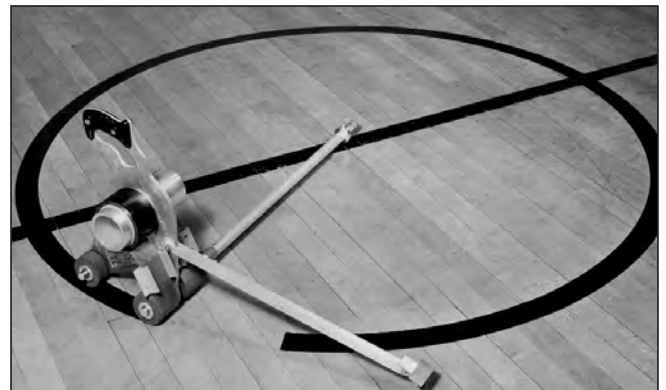

PART NO.	DESCRIPTION	SHIPPING WT.	CONTRACTOR PRICE
8TAPER	Tape Machine Complete	25 lbs.	\$740.00
8POLE	(Optional) 3-Point ext. pole kit w/dolly for NCAA 19'9" radius basketball 3-point line	20 lbs.	\$220.00/kit



ACRYLIC RESURFACER

Description:

REC-TECH Acrylic Resurfacer, applied to asphalt or concrete surfaces, fills surface voids and imperfections and helps provide a smooth, well prepared surface. This 100% acrylic emulsion is designed for onsite mixing with silica sand and water.

Coverage:

Coverage is approximately .07 to .09 gallons per square yard, per coat. Coverage is based on undiluted gallons of Acrylic Resurfacer and will vary according to the porosity and texture of the surface.

Mixing Directions

Patching Materials - For Use on Lifts up to 1/4"

Acrylic Resurfacer	10 Gallons
Water	5 Gallons
Sand	200 Lbs. (30-40 Mesh AFS)
Cement	1/2 Gallon

(Combine Cement and a small amount of Water before adding to Patching Material Mix)

Coating Material Use

Acrylic Resurfacer	55 Gallons
Water	33 Gallons
Sand	800 Lbs. (50-70 Mesh AFS)

NOTE:

Temperature must be at least 50°F and rising during application and for at least 24 hours after application. Do not apply if rain is imminent or forecast for the next 24 hours.

Available Colors:



*These printed colors may vary from actual product colors.



PART NO.	DESCRIPTION	SHIPPING WT.	CONTRACTOR PRICE
3RTAR5	5 Gal. Pail	48 lbs.	\$82.00/ea.
3RTAR55	55 Gal. Drum	526 lbs.	872.00/ea.

ACRYLIC BINDER

Description:

REC-TECH Acrylic Binder is a 100% acrylic emulsion designed to be mixed with sand and portland cement. Patch mixes based on Acrylic Binder are designed for filling low spots up to 1/2" deep.

Mixing & Coverage:

Acrylic Binder 4 gals. • Sand 100 lbs. • Cement 15-25 lbs. • Water up to .75 gals. Mix all material together prior to adding Rec-Tech Acrylic Binder. 1 gallon will yield approximately 1 square yard or 9 square feet at 1/4" depth.

Mixing Directions

A drill with mixing attachment is preferred, although, material may be mixed by hand.

Silica Sand	100 Lbs.
Portland Cement	30 Lbs.

Mix dry sand and dry cement first. Then, continue to add:

Acrylic Patch Binder	3 1/2 Gallons
Water	1/2 Gallon

Mix ingredients for 2-4 minutes. DO NOT OVER MIX.



NOTE:

Temperature must be at least 50°F and rising during application and for at least 24 hours after application. Do not apply if rain is imminent or forecast for the next 24 hours.



PART NO.	DESCRIPTION	SHIPPING WT.	CONTRACTOR PRICE
3RTAB5	5 Gal. Pail	48 lbs.	\$163.00/ea.
3RTAB55	55 Gal. Drum	500 lbs.	1799.00/ea.

ACRYLIC PRIMER

Description:

REC-TECH Acrylic Primer is a 100% acrylic emulsion for use on asphalt and concrete surfaces. It can be used as a priming material and will help with the adhesion of REC-TECH Color Coat.

Coverage:

Coverage is approximately 200-300 square feet per gallon. Coverage will vary according to the porosity and texture of the surface.

PART NO.	DESCRIPTION	SHIPPING WT.	CONTRACTOR PRICE
3RTAP5	5 Gal. Pail	47 lbs.	\$67.00/ea.
3RTAP55	55 Gal. Drum	511 lbs.	782.00/ea.



NOTE:

Temperature must be at least 50°F and rising during application and for at least 24 hours after application. Do not apply if rain is imminent or forecast for the next 24 hours.





ACRYLIC POURABLE CRACK FILLER

Description:

REC-TECH Acrylic Pourable Crack Filler is a 100% acrylic elastomeric liquid crack filler that has outstanding low-temperature flexibility and elasticity. It is designed for use in cracks up to 1/2" wide in asphalt or concrete recreational surfaces.

Coverage:

Acrylic Pourable Crack Filler will fill approximately 75-150 linear feet per gallon of cracks depending upon depth and width of cracks.

Available Colors:



Green



Neutral



Red

*These printed colors may vary from actual product colors.

NOTE:

Temperature must be at least 50°F and rising during application and for at least 24 hours after application. Do not apply if rain is imminent or forecast for the next 24 hours.

PART NO.	DESCRIPTION	SHIPPING WT.	CONTRACTOR PRICE
3TCCSP1	1 Gal. Jug	11 lbs.	\$35.00/ea.



ACRYLIC TROWEL GRADE FILLER

Description:

REC-TECH Trowel Grade Filler is a 100% acrylic formula made for filling small or large cracks in asphalt or concrete tennis courts.

Coverage:

Trowel Grade Filler will fill approximately 75-100 feet of cracks, depending upon depth and width of repair.

Available Colors:



Green



Neutral



Red

*These printed colors may vary from actual product colors.

NOTE:

Temperature must be at least 50°F and rising during application and for at least 24 hours after application. Do not apply if rain is imminent or forecast for the next 24 hours.

PART NO.	DESCRIPTION	SHIPPING WT.	CONTRACTOR PRICE
3TCCS1	1 Gal. Pail	17 lbs.	\$22.00/ea.



TENNIS COURT LINE PAINT

Description:

REC-TECH Tennis Court Line Paint is a textured, 100% acrylic emulsion paint, designed for use on asphalt and concrete tennis courts.

Coverage:

Tennis Court Line Paint will cover approximately 500-600 linear feet of 2" line per gallon.

PART NO.	DESCRIPTION	SHIPPING WT.	CONTRACTOR PRICE
3RTTCLP1	1 Gal. Jug	13 lbs.	\$39.00/ea.
3RTTCLP5	5 Gal. Pail	65 lbs.	191.00.00/ea.

NOTE:

Temperature must be at least 50°F and rising during application and for at least 24 hours after application. Do not apply if rain is imminent or forecast for the next 24 hours.



THANK YOU!

**Everyone
wants to
seal your
parking lot**



**For an Authorized J-16
Applicator in your area
Call 800-892-6701**



MAINTENANCE, INC.®

**THANK YOU FOR YOUR BUSINESS!
85+ YEARS AND STILL GOING STRONG!**

5% OFF ORDER
Excluding Bulk Sealer & Equipment

5% OFF ORDER
Excluding Bulk Sealer & Equipment

5% OFF ORDER
Excluding Bulk Sealer & Equipment

5% OFF ORDER
Excluding Bulk Sealer & Equipment

5% OFF ORDER
Excluding Bulk Sealer & Equipment



EXPLODED VIEW & PARTS LISTING

PX8 METAL

Reduced Stroke-Fitted

EXPLODED VIEW

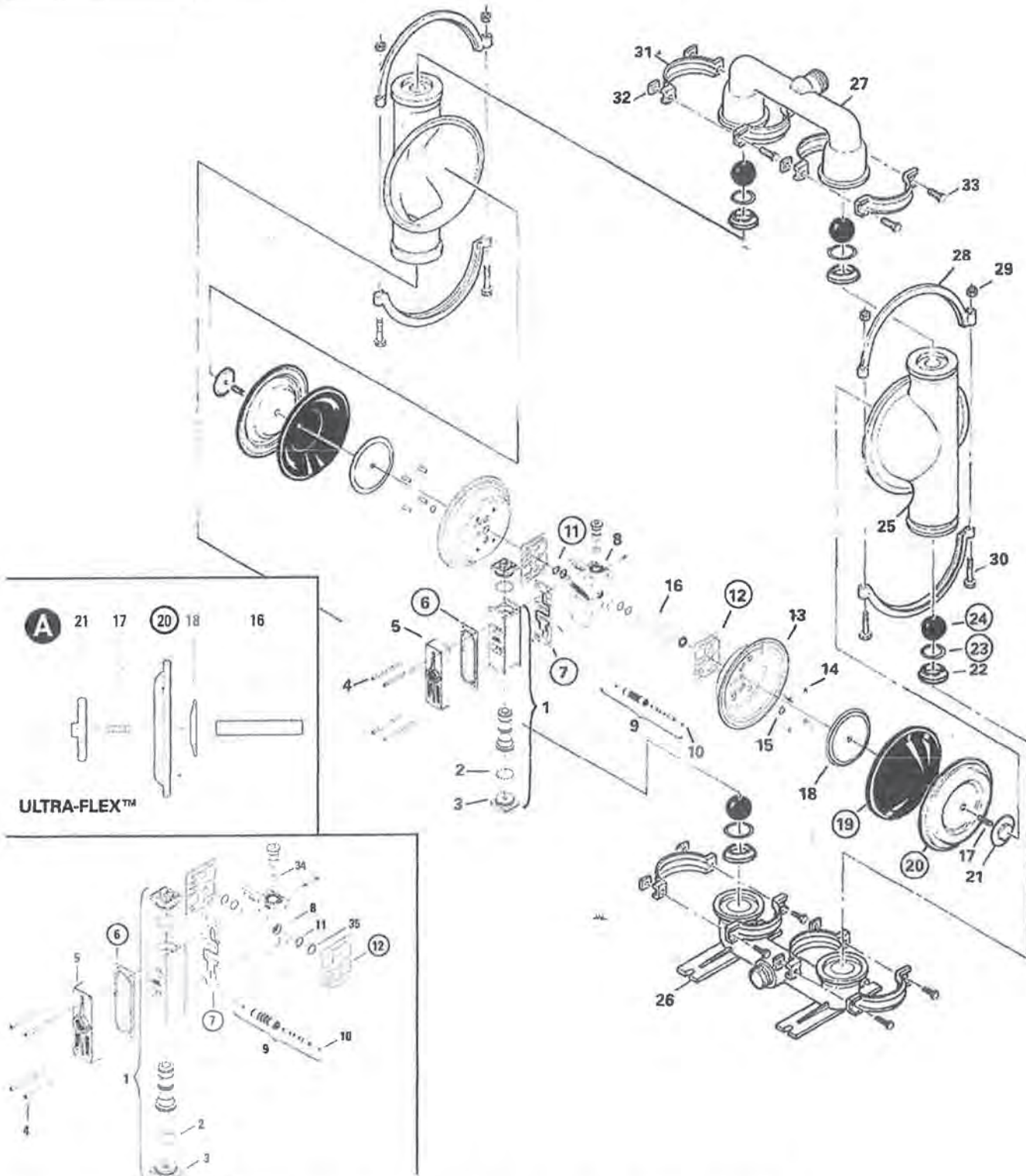

ALL CIRCLED PART IDENTIFIERS ARE INCLUDED IN REPAIR KITS (see section 9).

WILDEN PUMP & ENGINEERING, LLC

WIL-10320-E-06

EXPLODED VIEW AND PARTS LISTING

PX4 METAL

Full-Stroke Diaphragm-Fitted

EXPLODED VIEW

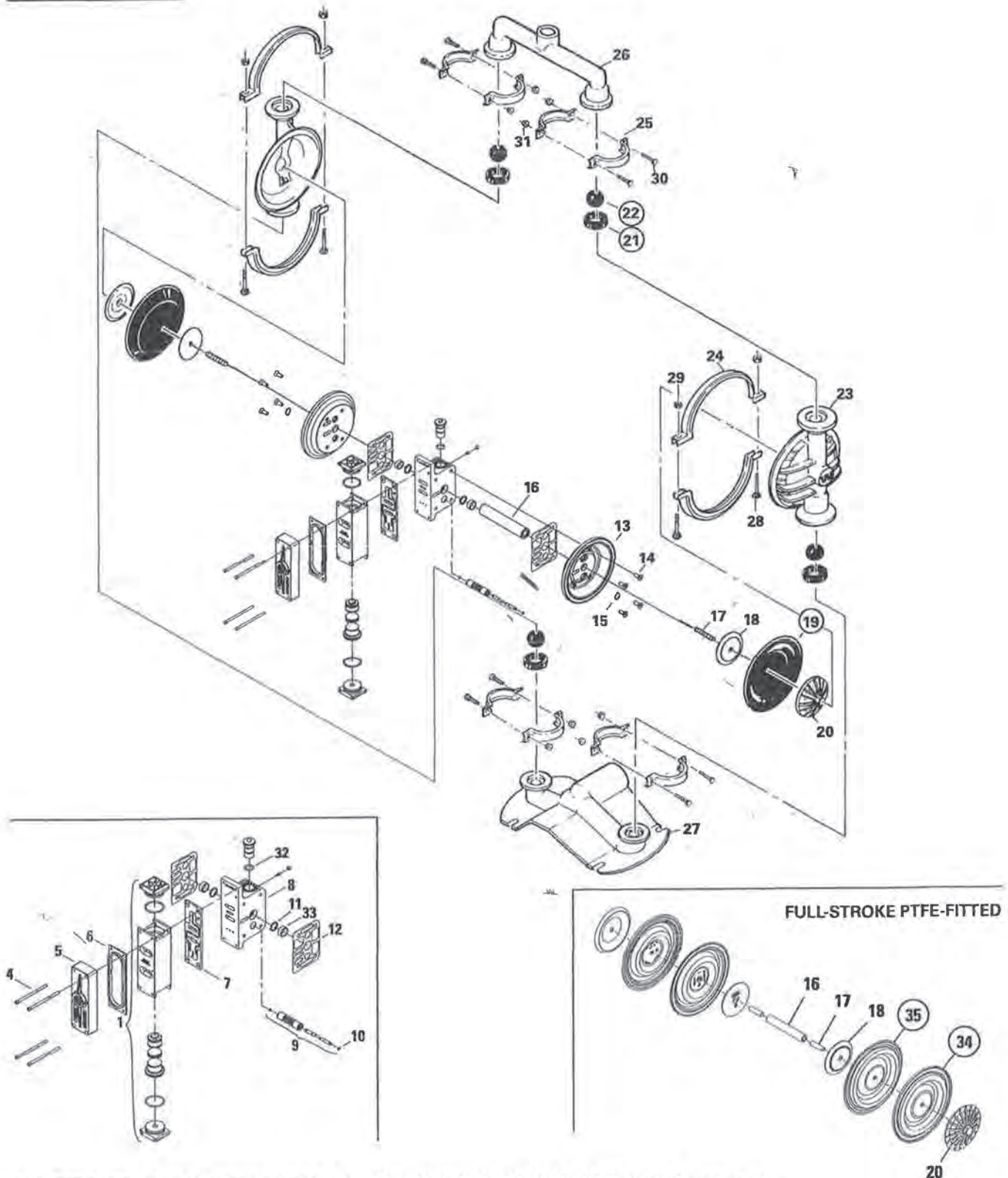

ALL CIRCLED PART IDENTIFIERS ARE INCLUDED IN REPAIR KITS (see Section 9).

575 Skid Spray System

Skid Mount 550 gal. Sealcoat Spray System

Call for Price

Can be shipped

Able's most sought after spray unit fits the need for today's contractor. Not too big, but big enough for the average job.

Standard Features:

- * GX 390 Honda
- * Full Sweep Agitation with rubber blades
- * Electric Start Rolair Compressor
- * 1½" Pump
- * Able's newest 2.5 gal Proflow Strainer Assembly
- * 100' Material Hose
- * Light Weight Spraywand
- * Sizes available- 300, 550

SIZE		APPROXIMATE WEIGHT
300 gallon		1450 lbs.
550 gallon		1600 lbs.
HEIGHT	WIDTH	LENGTH
60"	48"	144"

Able Aidewinder Pickup Unit

Able Pickup Truck SideWinder

Designed for the contractor just starting out or the established pro just needing to add a driveway unit. The ABLE 300 gal. hand agitated spray system fits the need. This unit comes complete and ready to go to work.

Standard Features:

- * Rolair Compressor
- * 1½" Sandpiper
- * 2 gal Strainer Assembly
- * 75' Material Hose
- * Light Weight Spraywand
- * Requires 8' Bed

APPROXIMATE WEIGHT		
1400 lbs.		
HEIGHT	WIDTH	LENGTH
52"	57"	156"

Call for Price



5.5 HP Pro Spray



Able Mini Spray System

Standard Features:

- * Attached to totes, drums, hand agitated units
- * High performance Rolair air compressor
- * 5.5 HP Honda engine
- * Original 2 gal. ABLE strainer assembly
- * BH Lightweight Spray Wand
- * 75' spray hose
- * 1½" Sandpiper Pump

Call for Price

Engine		APPROXIMATE WEIGHT	
GX 160 Honda		220 lbs.	
HEIGHT	WIDTH	LENGTH	
33"	22"	41"	

9 HP Pro Spray

Able Mini Spray System

Standard Features:

- * Attached to totes, drums, hand agitated units
- * High performance Rolair air compressor
- * 9.0 HP Honda engine
- * Original 2 gal. ABLE strainer assembly
- * BH Lightweight Spray Wand
- * 75' spray hose
- * 1½" Sandpiper Pump

Engine		APPROXIMATE WEIGHT	
GX 270 Honda		440 lbs.	
HEIGHT	WIDTH	LENGTH	
50"	25"	56"	



Call for Price

Pro Spray Accessories



PART NO.	DESCRIPTION	PRICE
8ADT	Able Drum Suction Tube	\$60.00
8ASH8	8' 2" Suction Hose	\$170.00
8ADTH8	Drum Tube & Hose Combo	\$210.00
8DRILL	Drill Mixer for 55 Gal Drum	\$35.00

Prices are Subject to Change

Complete Strainer Assembly



Strainer Baskets For All Brands



PART NO.	DESCRIPTION	PRICE
8ASB1/8	Able Strainer Basket 1 Gal 1/8" holes	\$72.00
8ASB1/4	Able Strainer Basket 1 Gal 1/4" holes	\$72.00
8ASB31/8	Able Strainer Basket 3 Gal 1/8" holes	\$90.00
8ASB31/4	Able Strainer Basket 3 Gal 1/4" holes	\$90.00
8ASMB1/4	Strainer Basket 1 Gal 1/4" holes - SealMaster	\$72.00
8ASMB31/8	Strainer Basket 3 Gal 1/8" holes - SealMaster	\$90.00
8ASMB31/4	Strainer Basket 3 Gal 1/4" holes - SealMaster	\$90.00
8ASR1/4	Strainer Basket 1 Gal 1/4' holes - Seal Rite	\$72.00
8ASR1/8	Strainer Basket 1 Gal 1/8' holes - Seal Rite	\$72.00
8AHAYB1/16	Strainer Basket 1 Qt 1/8" holes - Hayward	\$72.00
8HAYB1/4	Strainer Basket 1 Qt 1/4" holes - Hayward	\$72.00
8ASKK4	Able Strainer and Knob Kit 4pk	\$37.00
8ASKK6	Able Strainer and Knob Kit 6pk	\$39.00
8ARK	Able Assembly Strainer Replacement Knob	\$7.00
8ASG	Able Strainer Gasket	\$12.00
8A6A	Gasket Adhesive	\$9.50
8APB	Basket Puller	\$17.00

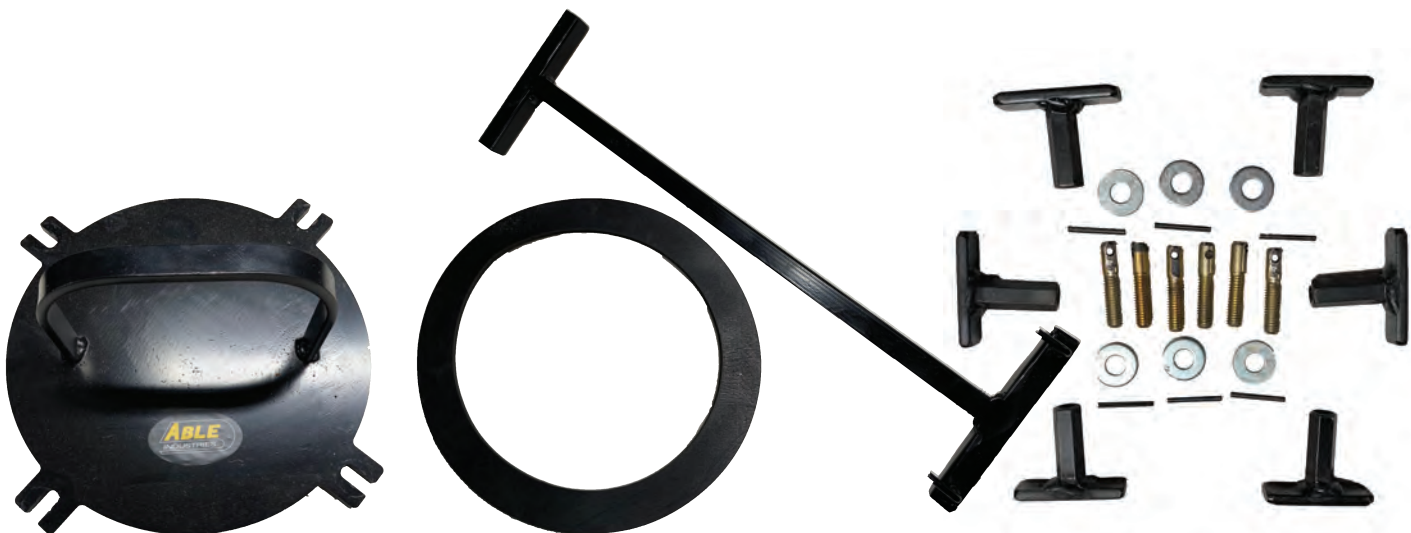

Pumps



PART NO.	DESCRIPTION	PRICE
8AWPX4	Wilden 1 1/2" Pump	Call
8AWPX8	Wilden 2" Pump	Call
8AWOR	Wilden O-Ring	\$2.00
8AWRPX4	Wilden 1-1/2" Pump Rebuild Kit - Wet End	\$260.00
8AWRPX8	Wilden 2" Pump Rebuild Kit - Wet End	\$278.00
8AWRAPX4	Wilden 1-1/2" Pump Rebuild Kit - Air End	\$440.00
8AWRAPX8	Wilden 2" Pump Rebuild Kit - Air End	\$440.00
8AWM1/2	Wilden Muffler 1-1/2"	\$109.00
8AWM2	Wilden Muffler 2"	\$109.00
8AWMGP	Wilden Air Motor Gasket Pump Side	\$15.00
8AWMGM	Wilden Air Motor Gasket Muffler Side	\$18.00
8AFL01	All-Flo Pump 1"	Call
8AFL01.5	All-Flo Pump 1-1/2"	Call
8AFL02	All-Flo Pump 2"	Call
8PD10A	ARO Pump 1-1/2"	Call
8PD20A	ARO Pump 2"	Call
8PD10RWK	ARO Rebuild Kit - Wet End 1-1/2"	\$495.00
8PD20RWK	ARO Rebuild Kit - Wet End 2"	\$495.00
8PD10RAK	ARO Rebuild Kit - Air End 1-1/2"	\$298.00
8PD20RAK	ARO Rebuild Kit - Air End 2"	\$348.00
8AS15B	Sandpiper Pump 1-1/2"	Call
8AS20B	Sandpiper Pump 2"	Call
8AS15BWK	Sandpiper Rebuild Kit - Wet End 1-1/2"	\$429.00
8AS20BWK	Sandpiper Rebuild Kit - Wet End 2"	\$390.00
8AS15BAK	Sandpiper Rebuild Kit - Air End 1-1/2"	\$638.00
8AS20BAK	Sandpiper Rebuild Kit - Air End 2"	\$638.00

Rebuild Kits



Bearing Blocks & Seal Kits



PART NO.	DESCRIPTION	PRICE
8ASURG	Surge Bottle	\$125.00
8SURG2L	Surge Tanks 13"x13' with 2" thread	\$130.00
8SURG2M	Surge Tanks 13"x10' with 2" thread	\$130.00
8SURG1.5	Surge Tanks 13"x10' with 1-1/2" thread	\$130.00

Hose Reel

Electric Hose Reel

Standard Features:

- * 1" Inlet/Outlet Available
- * Holds 100' 3/4 hose
- * 1/3 H.P. 12 Volt D.C. Motor
- * Pre-wired Heavy Duty Push Button Switch
- * Solenoid Included & Mounted



Manual Hose Reel

Standard Features:

- * 1" Inlet/Outlet Available
- * Holds 100' 3/4 hose
- * Steel Crank Handle With Free Turning Hand Grip



Spray Wand Material Hose

High performance reinforced Goodyear 3/4" red 250 psi pliovic hose. Cut length sizes include stainless hose clamps.



PART NO.	DESCRIPTION	SHIPPING WT.	PRICE
8HOSE	Spray Wand Material Hose	22 lbs./cwf	50 ft. Roll \$91.00
			75 ft. Roll \$136.50
			100 ft. Roll \$182.00

PART NO.	DESCRIPTION	PRICE
8AHRM	Hose Reel, Manual	\$443.00
8AHRE	Hose Reel, Electric	\$920.00

Ball & Molasses Valves

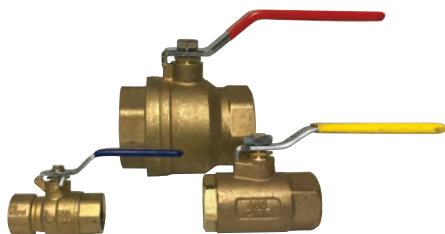

PART NO.	DESCRIPTION	PRICE
8LWSW/A	Ball Valve 3/4"	\$35.00

Plumbing



PART NO.	DESCRIPTION	PRICE
8AMQDC	Male QD Coupler to Pipe	\$26.00
8AFQDB	Female QD Coupler to Hose Barb	\$27.00
8AMQDB	Male QD Coupler to Hose Barb	\$27.00
8AFQDC	Female QD Cap	\$21.00
8A3/4HA	3/4" Hose Barb	\$15.00
8A2HB	2" Hose Barb	\$29.00
8AHS3/4	3/4" Sprayguard Swivel	\$38.00

Sprockets & Chains



PART NO.	DESCRIPTION	PRICE
8ALJC	Love Joy Coupler	\$58.00
8ALJS	Love Joy Sock L090/L095	\$22.00
8A50PML	Master Links 50P	\$7.00
8A50PC	50 Pitch Heavy Duty Chain 10' per box	\$47.00
8A50PDS	50 Pitch Sprocket 1-1/2" with 48 teeth	\$133.00
8A50PSDS	50 Pitch SDS 1-1/2"	\$35.00
8A50PS3/4	50 Pitch Sprocket 3/4"	\$39.00
8A509S1	50 Pitch Sprocket 1"	\$27.00
8A509S24T	50 Pitch Sprocket 1-1/2" with 24 teeth	\$79.00
8A50PB	50 Pitch Sprocket Bushing, 1-1/2" SDS	\$34.00
8A60PML	Master Links 60P	\$7.00
8A60PC	60 Pitch Heavy Duty Chain 10' per box	\$49.00
8A60PDS	60 Pitch Sprocket 1"	\$32.00
8A60PS	60 Pitch Sprocket 2" with 45 teeth	\$139.00
8A60PSDS2	60 Pitch Sprocket 2" SDS	\$62.00
8A60PB	60 Pitch Sprocket Brushing 2" SF2	\$41.00

Bearing Blocks & Seal Kits



PART NO.	DESCRIPTION	PRICE
8ABB3/4	Bearing Block 3/4"	\$47.00
8ABB1	Bearing Block 1"	\$66.00
8ABB1.5	Bearing Block 1-1/2"	\$76.00
8ABB2	Bearing Block 2"	\$120.00
8ABB27/16	Bearing Block 2-7/16"	\$114.00
8ABB215/16	Bearing Block 2-15/16"	\$223.00
8ABB3	Bearing Block 3"	\$145.00
8ABBSK1	Bearing Block Seal Kit 1"	\$39.00
8ABBSK1.5	Bearing Block Seal Kit 1-1/2"	\$47.00
8ABBSK2	Bearing Block Seal Kit 2"	\$52.00
8ABBSK27/16	Bearing Block Seal Kit 2-7/16"	\$54.00
8ABBSK215/16	Bearing Block Seal Kit 2-15/16"	\$54.00
8ABBSK3	Bearing Block Seal Kit 3"	\$54.00

Hydraulic



PART NO.	DESCRIPTION	PRICE
8AHCV	Hydraulic Control Valve	\$296.00
8AHYDR	Hydraulic Reservoir Tank	\$153.00
8AHYDM	Hydraulic Motor	\$358.00
8AHMB	Hydraulic Motor Bracket	\$75.00
8AHHOSE	Hydraulic Hose – per foot	Call
8GX200	200 CC – Pull Start	Call
8GX270	270 CC – Pull Start	Call
8GX270E	270 CC – Electric Start	Call
8GX390E	390 CC – Electric Start	Call



Air Compressors & Parts



PART NO.	DESCRIPTION	PRICE
8A13HPC	13 HP Rol-Air Compressor, 30 gal	Call
8APS9	9 HP Rol-Air Compressor, 30 gal	Call
8A9HPC	9 HP Rol-Air Pro Spray Compressor, 9 gal	Call
8A6HPC	6.5 HP Rol-Air Pro Spray Compressor, 9 gal	Call
8ARUV	Rol-Air Unloader Valve	\$109.00
8AEMUV	Emglo Unloader Valve	\$55.00
8ARCO	Compressor Oil, Quart	\$15.00
8ABOX	Battery Box	\$85.00



Troubleshooting Guide

Symptom:	Potential Cause(s)	Recommendation(s):
Pump Cycles Once	Deadhead (system pressure meets or exceeds air supply pressure).	Increase the inlet air pressure to the pump. Pump is designed for 1:1 pressure ratio at zero flow. (Does not apply to high pressure 2:1 units)
	Air valve or intermediate gaskets installed incorrectly.	Install gaskets with holes properly aligned.
	Bent or missing actuator plunger.	Remove pilot valve and inspect actuator plungers.
Pump Will Not Operate/Cycle	Pump is over lubricated.	Set lubricator on lowest possible setting or remove. Units are designed for lube free operation.
	Lack of Air (line size, PSI, CFM).	Check the air line size and length, compressor capacity (HP vs. CFM required)
	Check air distribution system.	Disassemble and inspect main air distribution valve, pilot valve and pilot valve actuators.
	Discharge line is blocked or clogged manifolds.	Check for inadvertently closed discharge line valves. Clean discharge manifolds/piping.
	Deadhead (system pressure meets or exceeds air supply pressure).	Increase the inlet air pressure to the pump. Pump is designed for 1:1 pressure ratio at zero flow. (Does not apply to high pressure 2:1 units)
	Blocked air exhaust muffler.	Remove muffler screen, clean or de-ice, and re-install.
	Pumped fluid in air exhaust muffler.	Disassemble pump chambers. Inspect diaphragm rupture or loose diaphragm plate assembly.
	Pump Chamber is blocked.	Disassemble and inspect wetted chambers. Remove or flush any obstructions.
Pump Cycles and Will Not Prime or No Flow	Cavitation on suction side.	Check suction condition (move pump closer to product).
	Check valve obstructed. Valve ball(s) not seating properly or sticking.	Disassemble the wet end of the pump and manually dislodge obstruction in the check valve pocket. Clean out around valve ball cage and valve seat area. Replace valve ball or valve seat if damaged. Use heavier valve ball material.
	Valve ball(s) missing (pushed into chamber or manifold).	Worn valve ball or valve seat. Worn fingers in valve ball cage (replace part). Check Chemical Resistance Guide for compatability.
	Valve ball(s) / seat(s) damaged or attacked by product.	Check Chemical Resistance Guide for compatability.
	Check valve and/or seat is worn or needs adjusting.	Inspect check valves and seats for wear and proper setting. Replace if necessary.
	Suction line is blocked.	Remove or flush obstruction. Check and clear all suction screens or strainers.
	Excessive suction lift.	For lifts exceeding 20' of liquid, filling the chambers with liquid will prime the pump in most cases.
	Suction side air leakage or air in product.	Visually inspect all suction-side gaskets and pipe connections.
	Pumped fluid in air exhaust muffler.	Disassemble pump chambers. Inspect for diaphragm rupture or loose diaphragm plate assembly.
Pump Cycles Running Sluggish/Stalling Flow Unsatisfactory	Over lubrication.	Set lubricator on lowest possible setting or remove. Units are designed for lube free operation.
	Icing.	Remover muffler screen, de-ice, and re-install. Install a point of use air drier.
	Clogged manifolds.	Clean manifolds to allow proper air flow.
	Deadhead (system pressure meets or exceeds air supply pressure).	Increase the inlet air pressure to the pump. Pump is designed for 1:1 pressure ratio at zero flow. (Does not apply to high pressure 2:1 units)
	Cavitation on suction side.	Check suction (move pump closer to product).
	Lack of air. (line size, PSI, CFM).	Check the air line size, length, compressor capacity.
	Excessive suction lift.	For lifts exceeding 20' of liquid, filling the chambers with liquid will prime the pump in most cases.
	Air supply pressure or volume exceeds system hd.	Decrease inlet air (press. and col.) to the pump. Pump is cavitating the fluid by fast cycling.
	Undersized suction line.	Meet or exceed pump connections.
	Restrictive or undersized air line.	Install a larger air line and connection.
	Suction side air leakage or air in product.	Visually inspect all suction-side gaskets and pipe connections.
	Suction line is blocked.	Remove flush obstruction. Check and clear all suction screens or strainers.
	Pumped fluid in air exhaust muffler.	Disassemble pump chambers. Inspect for diaphragm rupture or loose diaphragm plate assembly.
	Check valve obstructed.	Disassemble the wet end of the pump and manually dislodge obstruction in the check valve pocket.
	Check valve and/or seat is worn or needs adjusting.	Inspect check valves and seats for wear and proper setting. Replace if necessary.
	Entrained air or vapor lock in chamber(s).	Purge chambers through tapped chamber vent plugs. Purging the chambers of air can be dangerous.
Product Leaking Through Exhaust	Diaphragm failure, or diaphragm plates loose.	Replace diaphragms, check for damage and ensure diaphragm plates are tight.
	Diaphragm stretched around center hole or bolt holes.	Check for excessive inlet pressure or air pressure. Consult Chemical Resistance Chart for compatability with products, cleaners, temperature limitations and lubrication.
Premature Diaphragm Failure	Cavitation.	Enlarge pipe diameter on suction side of pump.
	Excessive flooded suction pressure.	Move pump closer to product. Raise pump/place pump on top of tank to reduce inlet pressure. Install Back pressure device (Tech bulletin 411r). Add accumulation tank or pulsation dampener.
	Misapplication (chemical/physical incompatibility).	Consult Chemical Resistance Chart for compatibility with products, cleaners, temperature limitations and lubrication.
	Incorrect diaphragm plates or plates on backwards, installed incorrectly or worn.	Check Operating Manual to check for correct part and installation. Ensure outer plates have not been worn to a sharp edge.
Unbalanced Cycling	Excessive suction lift.	For lifts exceeding 20' of liquid, filling the chambers with liquid will prime the pump in most cases.
	Undersized suction line.	Meet or exceed pump connections.
	Pumped fluid in air exhaust muffler.	Disassemble pump chambers. Inspect for diaphragm rupture or loose diaphragm plate assembly.
	Suction side air leakage or air in product.	Visually inspect all suction-side gaskets and pipe connections.
	Check valve obstructed.	Disassemble the wet end of the pump and manually dislodge obstruction in the check valve pocket.
	Check Valve and/or seat is worn or needs adjusting.	Inspect check valves and seats for wear and proper setting. Replace if necessary.
	Entrained air or vapor lock in chamber(s).	Purge chambers through tapped chamber vent plugs.



WWW.MAINTINC.COM • 1-800-892-6701

Maintenance, Inc.....Over 80 years and still going strong

ORDERING INFORMATION

PAYMENT TERMS: Our terms are Net 30 Days to rated firms (subject to late payment charge of 1-1/2% per month). If you are not a rated firm, but wish to establish 30-day credit, we will need one (1) bank reference and three (3) trade references with addresses, phone numbers, and fax numbers. Visit www.maintinc.com to get an application for credit form.

PRICES: Effective March 1, 2022 All prices are subject to change without notice.

STATE AND LOCAL SALES TAX: Any applicable sales tax will be added to the order, unless you furnish us with an exemption certificate.

TRANSPORTATION TERMS: All prices are F.O.B. Shipping Point.

LOSS OR DAMAGE: The carrier is responsible for any losses or damages sustained in transit. Claims should be made promptly against the carrier. Be sure any shortages or damages are noted on the carrier's delivery receipt and initialed by the driver. We will gladly assist you in securing adjustment.

RETURNS: No returns will be accepted without our written approval. Credit for such authorized returns (subject to condition of material) will be issued at the original purchase price less a 25% restocking and handling charge. An additional charge of 10% per month will be made on products having a limited shelf life. Transportation charges will be for the account of the customer.

- *Easy Ordering*
- *Complete Product Information*
- *Expert Advice*
- *Courteous Customer Service*

CALL 1-800-892-6701
(8:00 a.m. to 5:00 p.m.
EST Weekdays)
FAX 24 Hours a Day:
1-800-264-2578
www.maintinc.com

WE WELCOME:



Most orders are shipped within 24 hours. If we are unable to fill your order immediately, we will give you a scheduled ship date.

TRADEMARKS

Fass-Dri, FSA, J-16, Lastek, Minco, Plasticon, Curon, and Rec-Tech are registered trademarks of Maintenance Inc. Gator Patch is a trademark of Maintenance Inc., Lid-Off is a trademark of Mepco. Oil-Flo is a trademark of Titan Chemical Co. Pro-Coater is a trademark of Power Brush Co. Driveway Medic is a trademark of Co-Fair Corp. Rolatape is a trademark of Rolatape Corp. E-Z Reacher is a trademark of arc mate mfg. corp.

MI-018 (4/22) PRINTED IN U.S.A.

All rights reserved. No portion of this publication, whether in whole or in part, can be reproduced without the express written consent of Maintenance Inc.®

© Copyright 2022 by Maintenance Inc.®